

SEE A.G.S. 100 FOR GENERAL INFORMATION.

28-7-46
Res 429/154

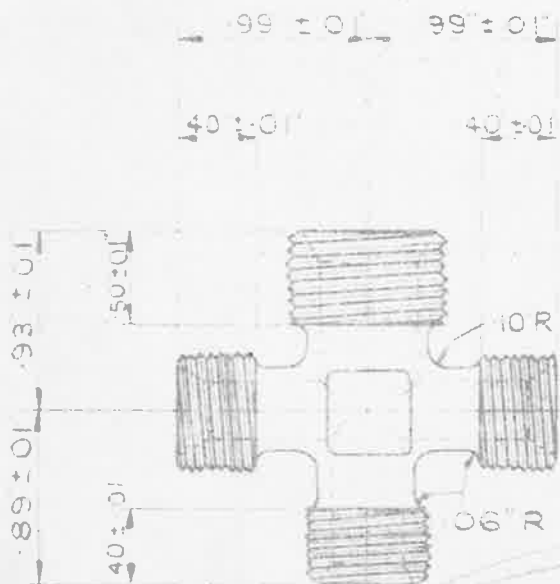

SMOOTH FINISH FREE FROM TOOL MARKS NOTE APPLIES TO ALL BRANCHES

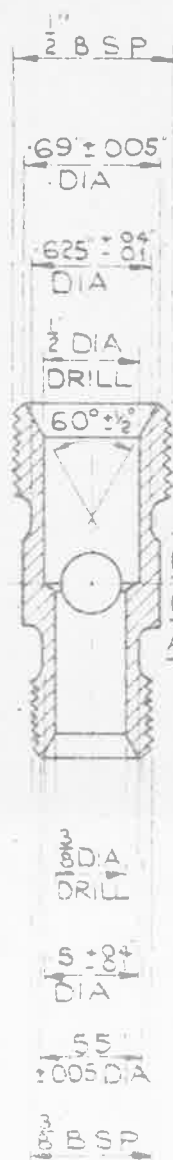

45° CHAMFER TO ROOT OF THREAD
NOTE APPLIES TO ALL BRANCHES

45 ± 0.01 SO

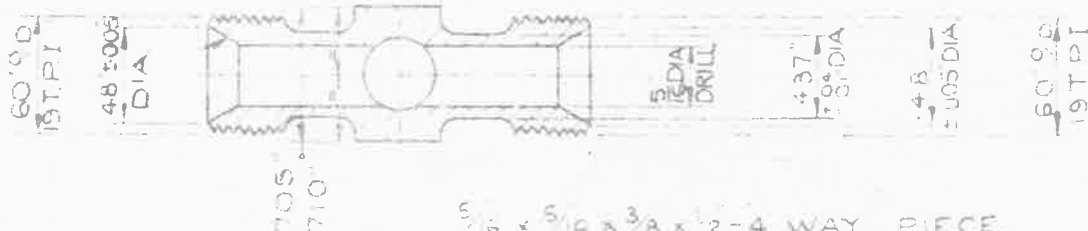

5/16 x 5/16 x 3/8 x 2-4 WAY PIECE

THE MATERIAL TO BE H.T. BRASS PRESSING TO B.S.S. 1001-1002 (LATEST ISSUE)

NOTES - SCREW THREADS TO B.S. SPEC No 84-1940
MEDIUM FIT TRUNCATED THREADS TO AMENDMENT No 3-1945.
WORKING PRESSURE 3,000 LB/SQ IN.
FOR ARRANGEMENT OF PIPE JOINTS SEE A.G.S. 1101

FINISH - TO BE CADMIUM PLATED TO SPEC. D.T.D. 904, (LATEST ISSUE),
ALTERNATIVELY, ELECTRO-TINNED, THICKNESS NOT LESS THAN .0002

ISSUED BY ROYAL AIRCRAFT ESTABLISHMENT	TITLE:- PIPE COUPLINGS UNION 4-WAY PIECE (UNEQUAL)				DRAWN: K.W. King	TRACED D.E.M.C. 28.5.46
	ISSUE No	1	2	3	3	CHECKED APPROVED
	ALTER No	100	267	98H	6M 856	C.T. Reynolds A.M.