

THIS A.G.S. WILL REPLACE THE CORRESPONDING SIZES OF A.G.S. 905 FOR ALL PURPOSES WHEN EXISTING STOCKS OF THE LATTER ARE EXHAUSTED.

ALL SHARP EDGES AND BURRS TO BE REMOVED

SEE A.G.S. 100 FOR GENERAL INFORMATION.

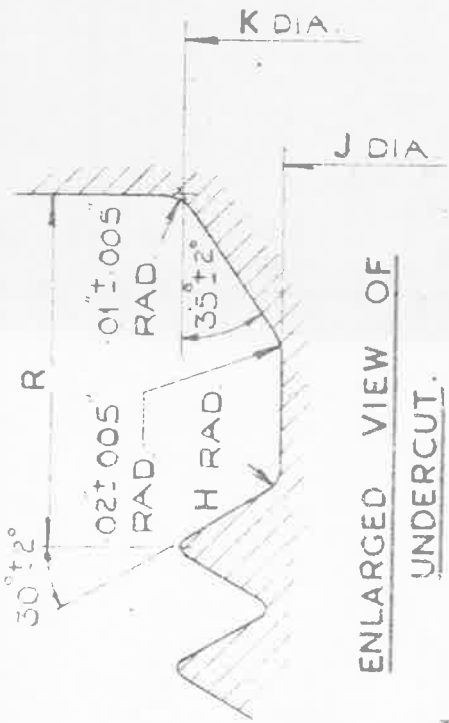

ENLARGED VIEW OF UNDERCUT.

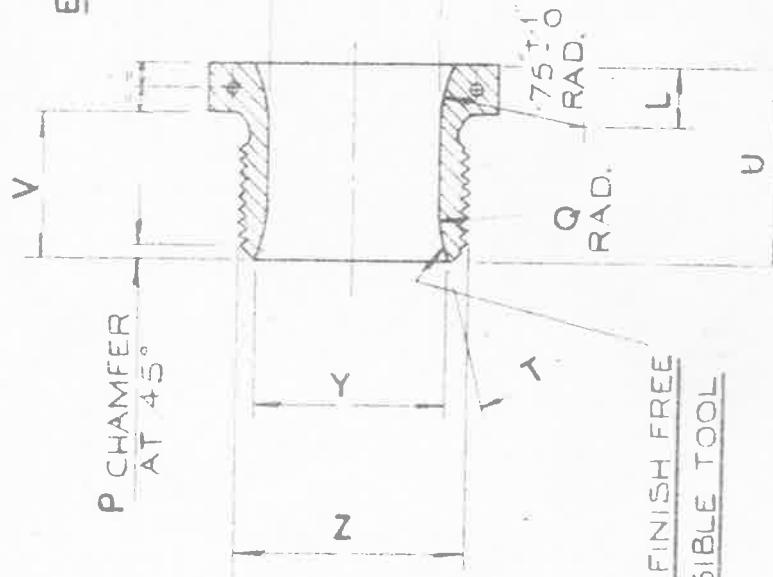

SMOOTH FINISH FREE FROM VISIBLE TOOL MARKS

A.G.S. 1218/* TO BE LEGIBLY AND DURABLY MARKED ON THIS OR OPPOSITE FACE (* MARK N^o)

MATERIAL: LIGHT ALLOY TO SPEC. OTD 423 (LATEST ISSUE)

FINISH: ANODISED TO SPEC. OTD 910 (LATEST ISSUE)

NOTE: SCREW THREADS TO B.S. SPEC. N^o 84: 1940, MEDIUM FIT, FOR DIAMETERS AND TOLERANCES OF MARKS B & CC SEE A.G.S. 100, SHEET 5.

TITLE:- PIPE COUPLINGS, STANDARD INNER SLEEVE

ISSUE	2	4	4
ALT. N ^o	AS/A.G.S. 812	AE/ACS 988	6M 856

MINISTRY OF SUPPLY

R.A.E. APPROVAL

AD. S.A.E. APPROVAL

APPLICATIONS FOR A.G.S. SHEETS TO:
ATP.4A. THAMES HOUSE, MILLBANK, S.W.1.

SIGNATURE: *C. S. R...* DATE: 9.5.50

SIGNATURE: *G. J. Gamber* DATE: 30/9/50

GENERAL INQUIRIES TO:-
AD. S.A.E. THAMES HOUSE, MILLBANK, S.W.1.

SHEET N^o: 1
N^o OF SHEETS: 2

A.G.S. N^o 1218

MARK	EXT. DIA. OF PIPE	Z	Y	X	W	V	U	T	S		R	Q	P	M	L	K	J	H
									MIN.	MAX.								
A	3 3/16	1 1/8	.250	13 3/64	.39	.50	.70	13 1/2°	440	445	.10	.20	.04	1 1/16	.20	.39	.330	.010
B	1 1/4	1 1/4	.345	17 3/64	.48	.55	.75	13 1/2°	520	525	.14	.20	.05	1 1/16	.20	.52	.440	.010
BB	5 1/16	19 T.P.I. .60% D	.415	21 3/64	.54	.60	.80	13 1/2°	595	600	.14	.20	.05	1 1/16	.20	.60	.525	.010
C	3 3/8	3 3/8	.483	25 3/64	.67	.60	.80	13 1/2°	705	710	.14	.50	.05	1 1/16	.20	.66	.580	.010
CC	7 1/16	14 T.P.I. .75% D	.540	29 3/64	.79	.70	.95	13 1/2°	815	820	.18	.50	.07	1 1/16	.30	.75	.650	.015
D	1 1/2	1 1/2	.605	33 3/64	.92	.70	.95	13 1/2°	915	920	.18	.50	.07	1 1/16	.30	.83	.720	.015
E	5 8/8	5 8/8	.735	41 3/64	.96	.70	.95	14°	1002	1010	.18	.50	.06	1 1/16	.30	.91	.800	.015
F	3 3/4	3 3/4	.860	49 3/64	1.06	.75	1.00	14°	1092	1100	.18	.50	.06	1 1/16	.30	1.05	.940	.015
G	7 3/3	7 3/8	.980	57 3/64	1.26	.75	1.00	14°	1292	1300	.18	.50	.07	078 (Nº 48)	.30	1.19	1.085	.015

TITLE:- PIPE COUPLINGS, STANDARD INNER SLEEVE.

MINISTRY OF SUPPLY

APPLICATIONS FOR A.G.S. SHEETS TO:- A.T.P.4A. THAMES HOUSE, MILLBANK, S.W.1.

GENERAL INQUIRIES TO:- AD.S.A.E. THAMES HOUSE, MILLBANK, S.W.1.

ISSUE: SM 352
ALT.Nº: AS/AGS 812

R.A.E. APPROVAL: SIGNATURE: [Signature], DATE: 9. 5. 50

AD. S.A.E. APPROVAL: SIGNATURE: [Signature], DATE: 30/3/50

SHEET Nº: 2
Nº OF SHEETS: 2

A.G.S. Nº 1218

APPROVED WORKING PRESSURE
 PIPE O/D. WORKING PRESSURE
 UP TO 1/2" 9,000 LB./SQ. IN.
 5/8" TO 7/8" 500 LB./SQ. IN.

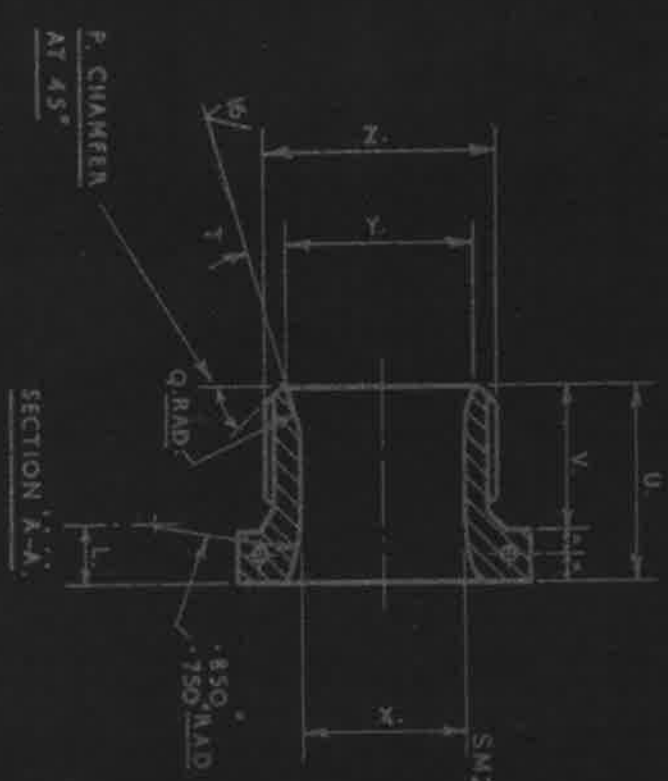
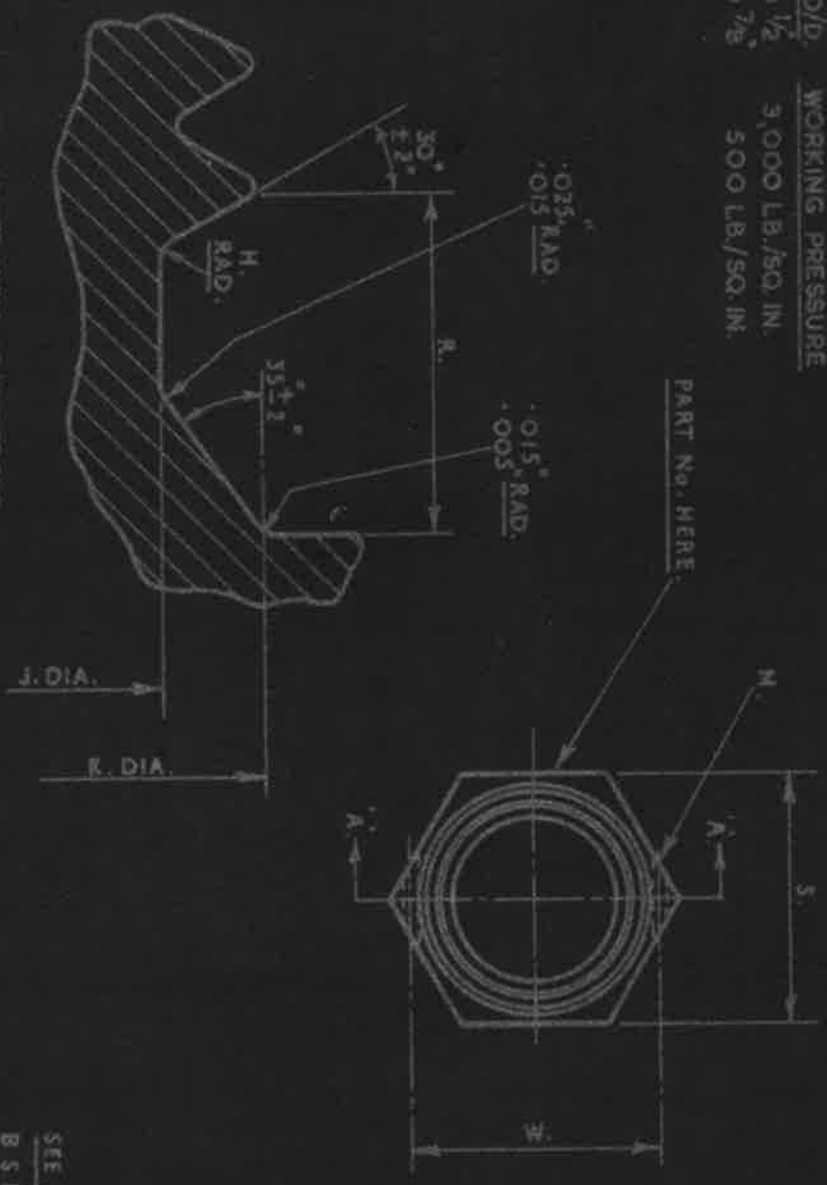

SEE A.G.S. 100 FOR GENERAL INFORMATION.
 B.S.P.F. THREADS TO B.S. SPEC. 2779, MEDIUM FIT TRUNCATED.

ENLARGED VIEW OF UNDERCUT.

ISSUE	ALT. No.
6	F.2.
7	F.46
8	F.96
9	F.101
10	F.119
11	F.123

USED ON	DRAWN	TRACED	CHECKED	APPROVED FOR	DATE	REF	DRAWING OR PART No.	DESCRIPTION	LIMITS NOT SHOWN	UNIT	MATERIAL - REMARKS
	F.A.C.	F.A.C.	F.A.C.	<i>[Signature]</i>	19.11.57			ALUMINUM ALLOY			L.85
DESIGNED	F.A.C.	F.A.C.	F.A.C.					PIPE COUPLINGS (ALUMINUM ALLOY) STANDARD INNER SLEEVE.	± 0.010		THIRD ANGLE PROJECTION.
ISSUED BY THE SOCIETY OF BRITISH AEROSPACE COMPANIES LTD., 29, KING STREET, ST. JAMES'S, LONDON, S.W. 1.											A.G.S. 1218 - SHEET 1.

PROCC 1000-1-13

SIZE B.1-8.113

SM2027

AG.S.1218 SHEET 2.

MARK	O/D OF PIPE	H	J	K	L	DRILL		P	Q	R	S	T		U	V	W	DRILL DIA.		Y	Z
						M	N					+ 1/2°	- 1/2°				X	Z		
A	3/16	.015	.330	.390	.205	1/16	.045	.230	.110	.445	15/2	.720	.520	.400	.13	.255	1/8			
B	1/4	.015	.440	.520	.205	1/16	.045	.230	.150	.525	15/2	.770	.570	.490	.17	.350	1/4			
B B	5/16	.015	.525	.600	.205	1/16	.045	.230	.140	.600	15/2	.820	.620	.550	.21	.420				
C	3/8	.015	.580	.660	.205	1/16	.045	.500	.130	.710	15/2	.820	.620	.680	.25	.480				
C C	7/16	.020	.650	.750	.305	1/16	.075	.530	.180	.820	15/2	.970	.720	.800	.29	.545				
D	1/2	.020	.720	.830	.305	1/16	.075	.530	.180	.915	15/2	.970	.720	.930	.33	.610				
E	5/8	.020	.800	.910	.305	1/16	.065	.530	.190	.920	14°	.970	.720	.970	.41	.740				
F	3/4	.020	.940	1.050	.305	1/16	.055	.530	.190	1.002	14°	1.020	.770	.950	.49	.865				
G	7/8	.020	1.085	1.190	.305	No 48 076 DIA.	.075	.530	.190	1.300	14°	1.020	.770	1.270	.57	.985				

THIS A.G.S. WILL REPLACE THE CORRESPONDING SIZES OF A.G.S. 905 FOR ALL PURPOSES WHEN EXISTING STOCKS OF THE LATTER ARE EXHAUSTED.

ISSUED BY THE SOCIETY OF BRITISH AIRCRAFT ENGINEERS LTD.,
18, KING STREET, ST. JAMES'S, LONDON, S.W.1.

DESIGNED BY	DRAWN BY	TRACED BY	CHECKED BY	APPROVED BY	DATE

PIPE COUPLINGS STANDARD INNER SLEEVE

A.G.S.1218 SHEET 2.

THIS IS A PHOTOGRAPHIC REDUCTION DRAWING MUST NOT BE SCALED

ETA-C-18-5170