

24-3-25  
A E PENN

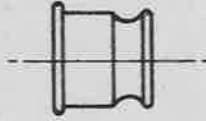

FULL SIZE VIEW OF SLEEVE

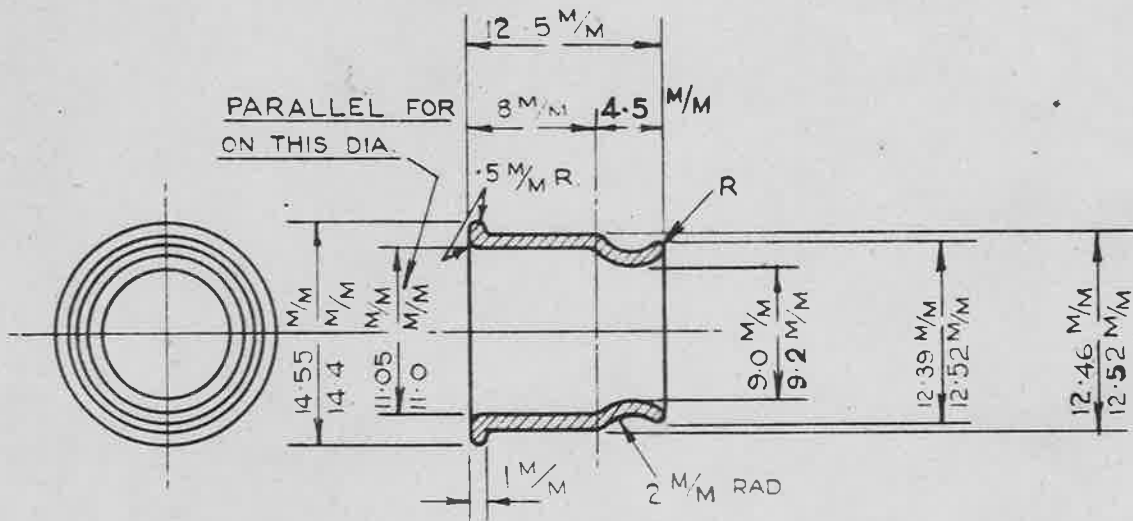

SCALE -  $\frac{2}{1}$

MAT: - BRASS TUBE: BEST COMMERCIAL QUALITY

IMPORTANT - ALL SHARP EDGES TO BE  
WELL ROUNDED OFF

*SUP*

ISSUE N <sup>o</sup>	6	X	8
ATTENTION N <sup>o</sup>	AGS/69	AGS/69	AGS/69
AD N <sup>o</sup>	AGS/69	AGS/69	AGS/69
MOD N <sup>o</sup>	AGS/69	AGS/69	AGS/69

ISSUED BY DRAWING OFFICE DIRECTORATE OF TECHNICAL DEVELOPMENT <b>AIR MINISTRY</b>	TITLE - SLEEVE (OUTER) FOR H.T. BRAIDED CABLE.					DRAWN G.H.	RE-TRACED D.E. YORK 11-1-39
	ISSUE N <sup>o</sup>	1	2	4	5	CHECKED G.H. 13-1-25	APPROVED G.E. BARSTO 4-1-25
	ALTERATION N <sup>o</sup>	AGS/69	AGS/86	AGS/145	MOD N <sup>o</sup> HGS/333	RE-CH (C.T. Reynolds 6-3-39) V.P.L.	

PENN



FULL SIZE VIEW OF SLEEVE.

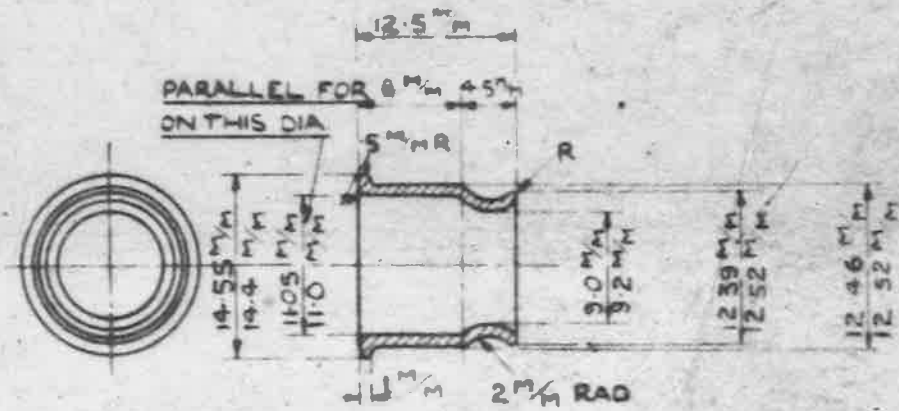

SCALE - 2/1

MAT - BRASS TUBE

FINISH ELECTRO TINNED THICKNESS NOT LESS THAN .0002

ALL SHARP EDGES TO BE

WELL ROUNDED OFF

6  
7  
8  
9

ISSUED BY DRAWING OFFICE DIRECTORATE OF TECHNICAL DEVELOPMENT AIR MINISTRY	TITLE - SLEEVE (OUTER) FOR HT METAL BRAIDED CABLE .95 mm DIA				DRWING 64	RE-TAKEN GENERAL
	ISSUE NO	1	2		CHECKED	66845
	ALTERED					4725

570

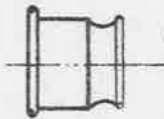

FULL SIZE VIEW OF SLEEVE.

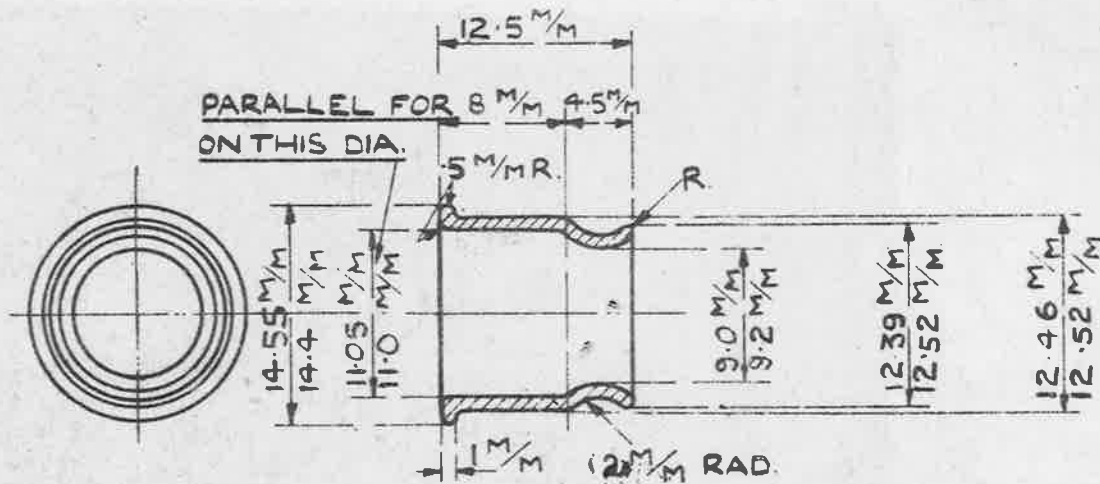

SCALE -  $\frac{2}{1}$

MAT<sup>L</sup> - BRASS TUBE.

FINISH: ELECTRO-TINNED, THICKNESS NOT LESS THAN .0002."

ALL SHARP EDGES TO BE

WELL ROUNDED OFF.

ISSUED BY  
ROYAL  
AIRCRAFT  
ESTABLISHMENT.

TITLE SLEEVES, BONDING, METAL BRAIDED  
CABLE, H.T. OUTER, STRAIGHT.

DR - W.M.  
G.H.

RE-TRACED  
DEYORK III:1:39

ISSUE No 10  
ALTERATION No 853

CHECKED  
G.H. 13:1:25  
RE. CH. (C.T. Reynolds)

APPROVED  
G.E. BAIRSTO.  
14:1:25

SM 68