

SCALE 2/1

UNLIMITED DIMENSIONS $\pm .02"$

AIR MINISTRY A.G.S. No. 1596

SHEET No. |

No. of SHEETS |

15-840
8.137138/40

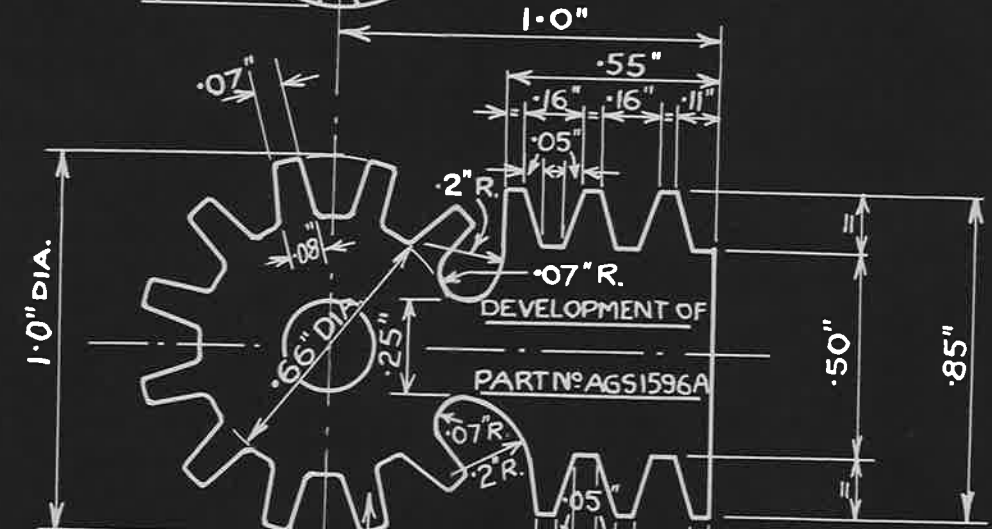
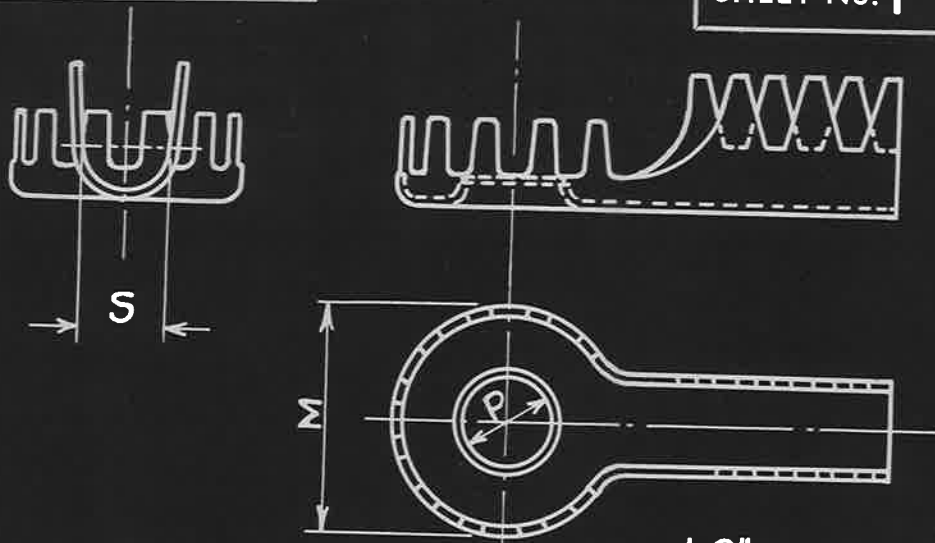

10 TEETH EQUALLY SPACED

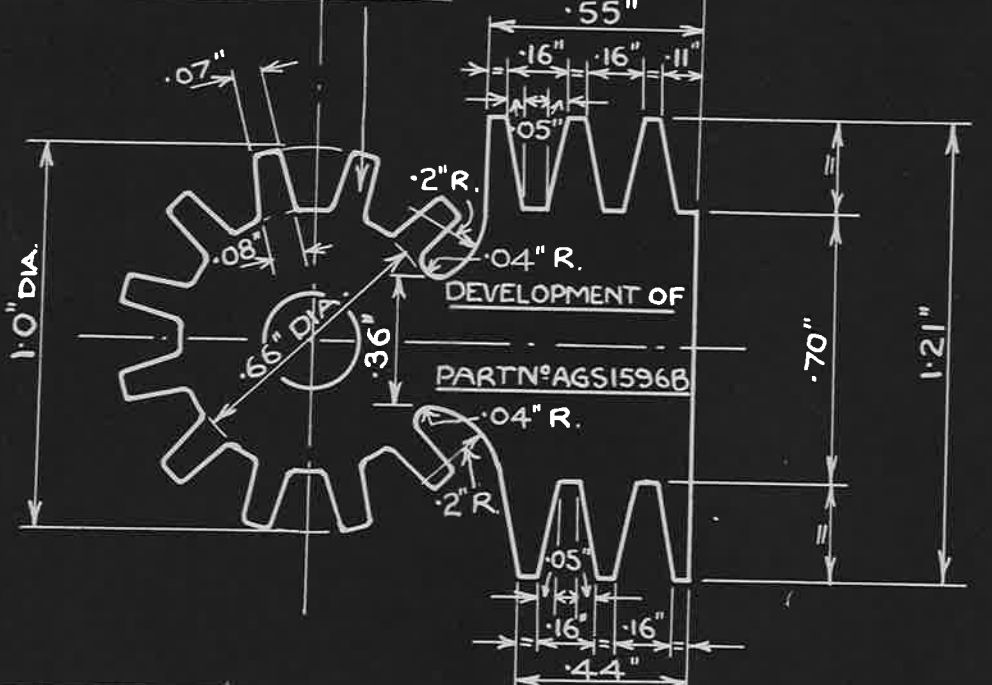

LOOSE WASHER
22 S.W.G.
1 OFF PER CABLE END

PART N°	CABLE	M DIA.	P DIA.	S DIA.	S.W.G.
1596 A	UNISHEATH4	.60"	.25"	.21"	22
1596 B	UNIPLUG	.60"	.25"	.31"	22

MATERIAL:- HARD ROLLED BRASS SHEET TO B.S. SPEC. N° 265 (LATEST ISSUE)

ISSUED BY DRAWING OFFICE DIRECTORATE OF TECHNICAL DEVELOPMENT AIR MINISTRY	TITLE— ENDS, CABLE, CLAW TYPE. O.B.A.		RETRACED FOR A.P.C. W.R.L. 24-9-41 YIC. RYS.	DRAWN C.T. Reynolds.	TRACED H.W. 5-7-40
	ISSUE No.	3			
	ALTERATION	MOD N° AGS/400 26/8/40			CHECKED <i>John Treacher</i>

SCALE 2/1

UNLIMITED DIMENSIONS ± 0.02"

AIR MINISTRY AGS No 1596

SHEET No 1 No of SHEETS 1

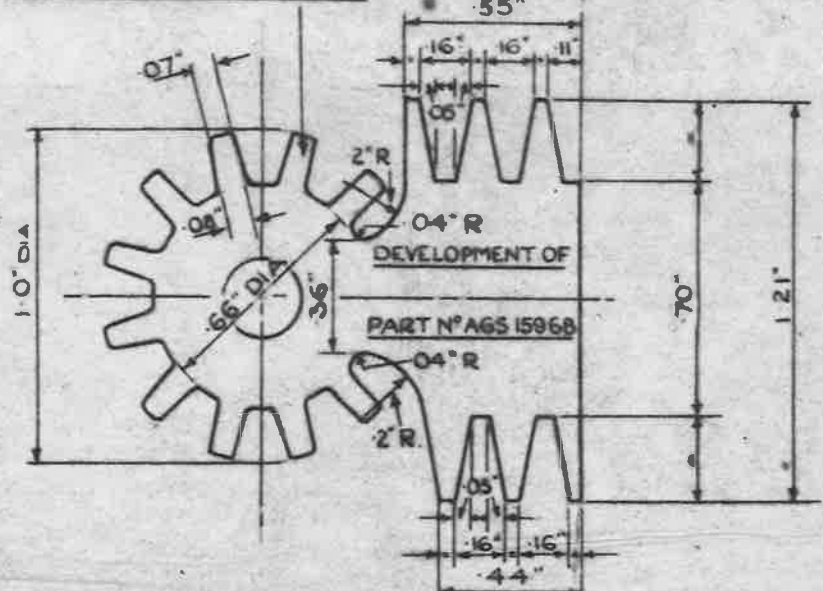
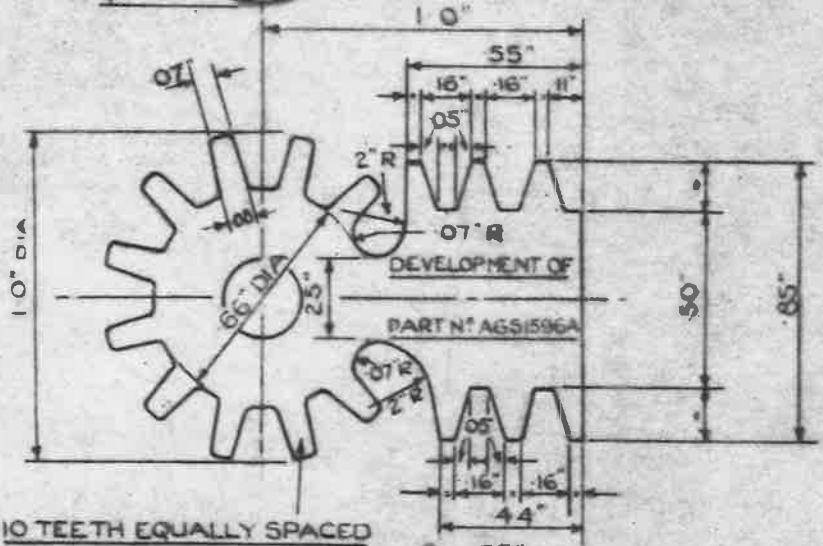
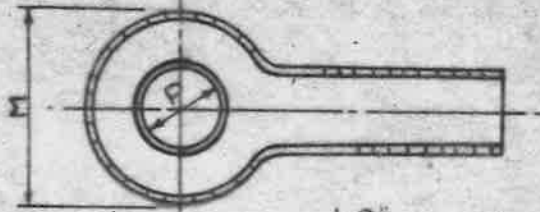
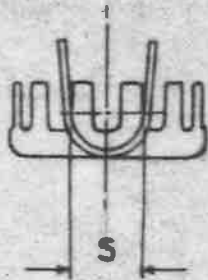

PART N°	CABLE	M DIA	P DIA	S DIA	SWG
1596 A	UNISHEATH 4	60"	25"	21"	22
1596 B	UNIPLUG	60"	25"	31"	22

MATERIAL - HARD ROLLED BRASS SHEET TO BS SPEC N° 265 (LATEST ISSUE)
 FINISH - ELECTRO-TINNED THICKNESS NOT LESS THAN 0.0002 OR NICKEL PLATED THICKNESS NOT LESS THAN 0.0005

ISSUED BY DRAWING OFFICE DIRECTORATE OF TECHNICAL DEVELOPMENT AIR MINISTRY	TITLE - ENDS, CABLE, CLAW TYPE OB A				DRAWN	TRACED
	ISSUE N°	3	4		CHECKED	APPROVED
	ALTERATION N°					

80218

SCALE 2/1

UNLIMITED DIMENSIONS ±.02"

AIR MINISTRY A.G.S. No 1596

SHEET No 1 No OF SHEETS. 1

OBSOLESCE - NOT TO BE USED IN NEW DESIGN WORK. SEE S.D.M. 256.

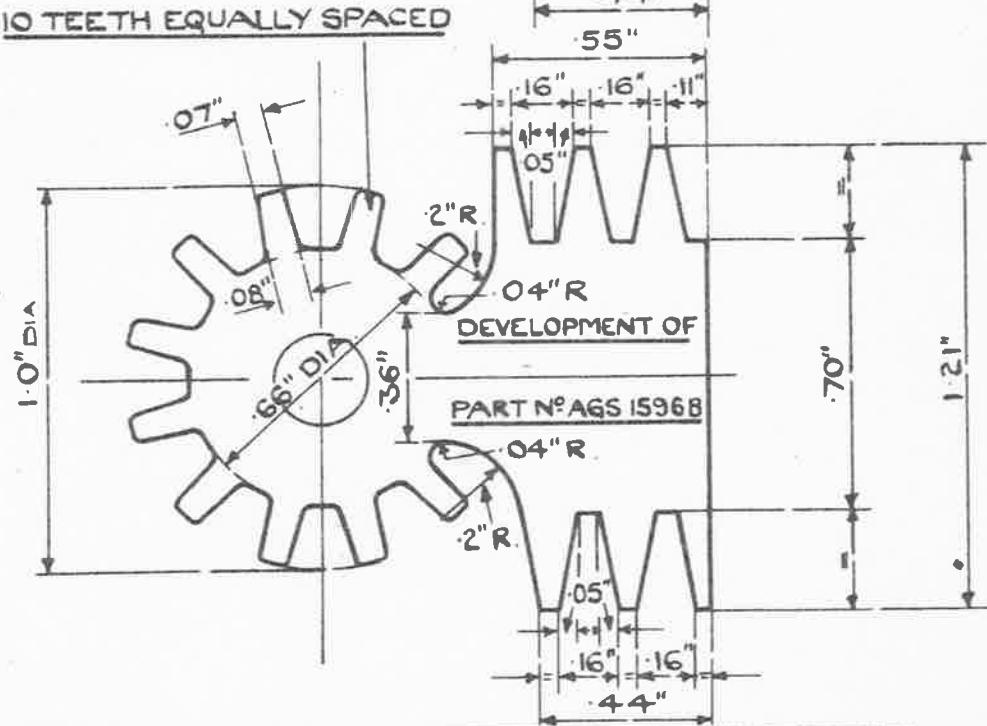
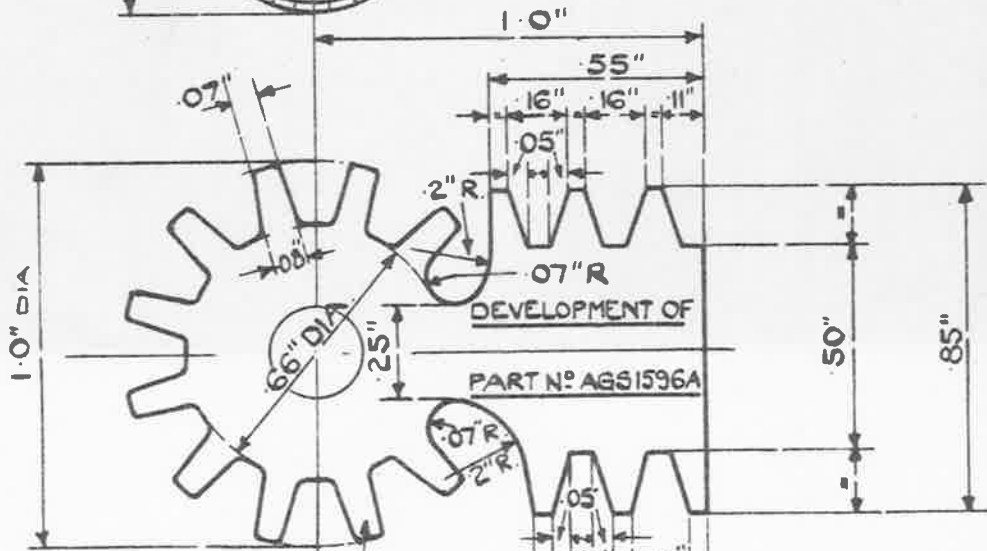
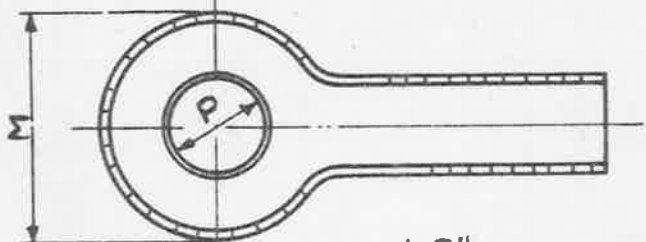
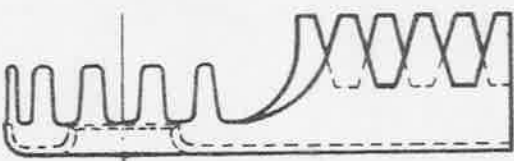
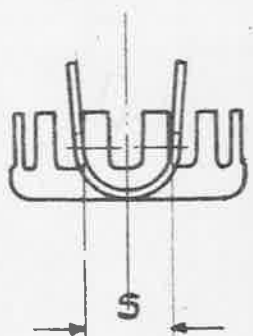

LOOSE WASHER
22 S.W.G.
1 OFF PER. CABLE END.

PART N°	CABLE	M. DIA.	P. DIA.	S. DIA.	S.W.G.
1596 A	UNISHEATH 4	.60"	.25"	.21"	22
1596 B	UNIPLUG	.60"	.25"	.31"	22

MATERIAL: - HARD ROLLED BRASS SHEET TO BS SPEC. No 265 (LATEST ISSUE)
FINISH: - ELECTRO-TINNED, THICKNESS NOT LESS THAN 0.0002, OR NICKEL PLATED THICKNESS NOT LESS THAN 0.0003.

ISSUED BY DRAWING OFFICE
DIRECTORATE OF
TECHNICAL DEVELOPMENT
AIR MINISTRY

TITLE:-
ENDS, CABLE, CLAW TYPE. O.B.A.
ISSUE N° 7-4 HS 5
ALTERATION N° AGS 400 AG 2-TR 973 SMT 9

DRAWN
C.T. Reynolds.
CHECKED
APPROVED
5-7-40
L.H. 2/40