

MATERIAL:- SOFT BRASS SHEET, 30 S.W.G.

TO B.S. SPEC<sup>n</sup> 265. (LATEST ISSUE)

FINISH:- ELECTRO-TINNED, THICKNESS NOT LESS THAN 0.0002, OR NICKEL PLATED

REF: N<sup>o</sup> HA/471. THICKNESS NOT LESS THAN 0.0003.

SCALE:- 1/1

ISSUED BY THE ROYAL AIRCRAFT ESTABLISHMENT.	TITLE:- TERMINAL EYELET.				DRAWN N.J.	TRACED JRO 25-1-43
	ISSUE N <sup>o</sup>	2-2			CHECKED G.L.M.	APPROVED [Signature]
	ALTER N <sup>o</sup>					

022

80518

**OBSOLESCE** - NOT TO BE USED  
IN NEW DESIGN WORK. SEE S.D.M. 256

MINISTRY OF  
AIRCRAFT  
PRODUCTION.

AGS. No 1745.

SHEET No 1 | No OF SHEETS 1

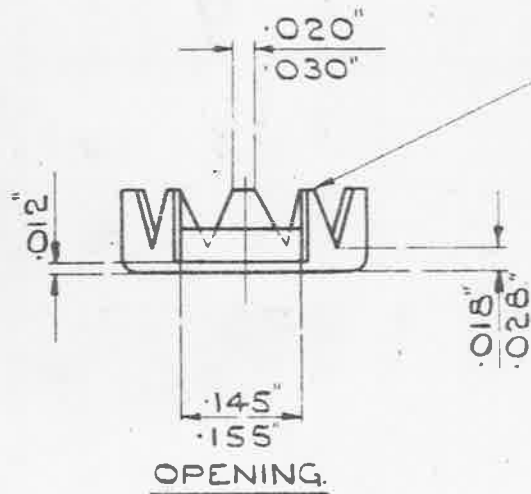

8 SERRATIONS EQUALLY  
SPACED, COMMENCING  
EACH SIDE OF OPENING  
WITH HALF SERRATION.

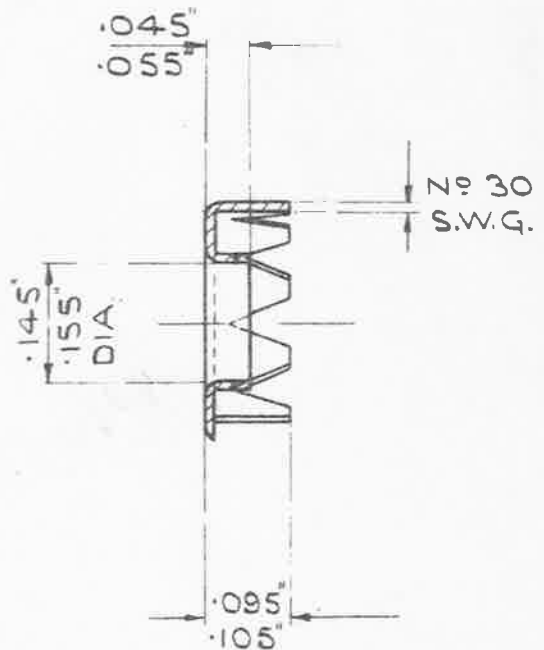
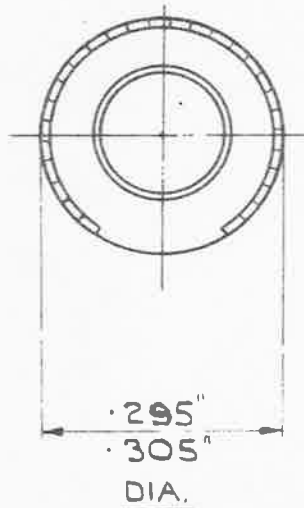

MATERIAL:- SOFT BRASS SHEET, 30 S.W.G.

TO B.S. SPEC<sup>n</sup> 265. (LATEST ISSUE)

FINISH:- ELECTRO - TINNED, THICKNESS NOT LESS THAN 0.0002", OR NICKEL PLATED,  
THICKNESS NOT LESS THAN 0.0003".

REF: No 11A/471

SCALE:- 4/1.

ISSUED BY THE ROYAL AIRCRAFT ESTABLISHMENT.	TITLE - TERMINAL EYELET.				DRAWN N.S.	TRACED JRO:25-1-43
	ISSUE No	1	2	3	CHECKED	APPROVED.
	ALTER <sup>n</sup> No	AGS/455	AGS/455	AGS/455	G.L.W.	