

AG.S. 2040.

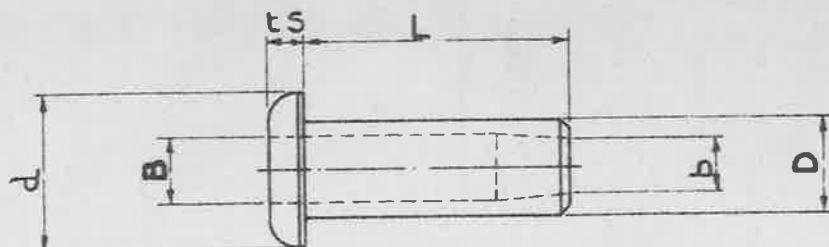

MANUFACTURING
DRAWING NO IS
RIVET DIA. IN
1/32 X 100/3
i.e. 1/8 RIVET IS 400/3.

THIS RIVET IS A PROPRIETARY ARTICLE MANUFACTURED BY :-
AVIATION DEVELOPMENTS LTD, KINGSBOURNE HOUSE, LONDON, W.C.1, AND KNOWN
COMMERCIALY BY THE MAKERS CODE T.K-SS, T.L-SS, AND THE R.220-SS
SERIES. FOR CALLING UP PURPOSES, HOWEVER, THE A.G.S. NUMBER IS TO
BE USED, FOLLOWED BY THE CODE NUMBER AS GIVEN IN THE TABLE.

LENGTH L INS.	PLATE THICKNESS TO BE RIVETED INS		CODE NUMBERS.					
	FROM	TO						
1/8	—	.064	404	504				
5/32	—	.064			605			
3/16	.064	.125	406	506				
7/32	.064	.125			607	807		
1/4	.125	.188	408	508				
9/32	.125	.188			609	809	1009	
5/16	.188	.250	410	510				
11/32	.188	.250			611	811	1011	1211
3/8	.250	.312		512				
13/32	.250	.312			613	813	1013	1213
7/16	.312	.375		514				
15/32	.312	.375			615	815	1015	1215
17/32	.375	.437			617	817	1017	1217
19/32	.437	.500			619	819	1019	1219
21/32	.500	.562				821	1021	1221
23/32	.562	.625				823	1023	1223
25/32	.625	.687				825	1025	1225
27/32	.687	.750					1027	1227
29/32	.750	.812					1029	1229
31/32	.812	.875						1231
33/32	.875	.937						1233
35/32	.937	1.000						1235
SHANK DIA. INS.	NOMINAL		1/8	5/32	3/16	1/4	5/16	3/8
	ACTUAL		.125 ±.002	.156 ±.002	.188 ±.002	.247 ±.002	.313 ±.002	.375 ±.002
DIA. OF HD. d	±.005 INS.		.210	.250	.344	.406	.531	.620
DIA. 'B'	INS.		.080 ±.002	.094 ±.002	.120 ±.002	.172 ±.002	.196 ±.002	.238 ±.002
DIA. 'b'	±.002" INS.		.060	.074	.098	.146	.169	.205
DEPTH OF HD. ts	±.005 INS.		.039	.052	.065	.078	.091	.104
MANDREL HD. DIA.	INS.		.088	.107	.132	.184	.210	.250
DRILL SIZE.	INS.		.128	.161	.191	.250	.316	.377

NOTE:- THE LAST TWO FIGURES OF THE CODE NUMBER REPRESENT THE LENGTH
IN 1/32; THE REMAINING FIGURE OR FIGURES, REPRESENTING THE DIA. IN 1/32

METHOD OF CALLING UP:- THE COMPLETE PART NUMBER FOR THE RIVET IS GIVEN
BY QUOTING THE A.G.S. NUMBER, WHICH DEFINES THE TYPE OF RIVET AND
THE MATERIAL, FOLLOWED BY THE CODE NUMBER TAKEN FROM THE TABLE
ABOVE, WHICH DEFINES THE SHANK DIA. AND LENGTH OF THE RIVET.

EXAMPLE:- A.G.S. 2040/410 IS A CHOBERT RIVET - MILD STEEL WITH SNAP
HEAD - 1/8" SHANK DIA. X 5/16" LONG.

NOTE:- RIVETS MAY BE USED WITH, OR WITHOUT SEALING PINS AS REQUIRED
SEALING PINS ARE LISTED ON A.G.S. 2042.

PROTECTIVE TREATMENT:- CADMIUM PLATE, TO SPEC: DTD 904. COLOUR IDENTIFICATION:- CADMIUM

TITLE RIVETS, CHOBERT,
STEEL, D.T.D. 951, SNAP HEAD.

ISSUE	SM 597						
ALT. NO.	MOD/AGS	878					
R.A.E. APPROVAL				A.D.S.A.E. APPROVAL			
SIGNATURE		DATE		SIGNATURE		DATE	
<i>[Signature]</i>		4.1.52.		<i>[Signature]</i>		6/6/52	
SHEET NO		1		A.G.S. No 2040.			
NO OF SHEETS		1					

MINISTRY OF SUPPLY
APPLICATIONS FOR A.G.S. SHEETS TO:-
A.T.R.4A. THAMES HOUSE, MILLBANK, S.W.1.

GENERAL INQUIRIES TO:-
A.D.S.A.E. THAMES HOUSE, MILLBANK, S.W.1.

ORIGINAL APPROVAL DATE 13.7.50.

AGS. 2040.

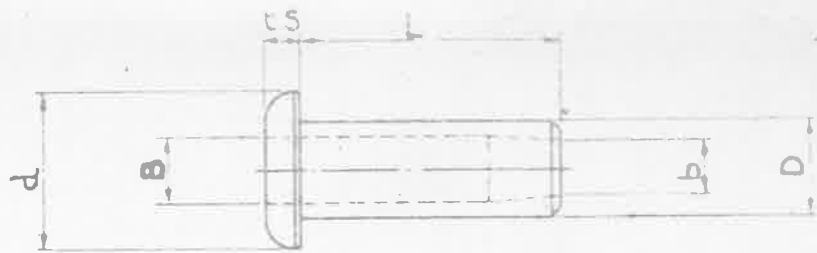

MANUFACTURING
DRAWING NO IS
RIVET DIA. IN
1/32" X 100/3
ie. 1/8 RIVET IS 400/3.

THIS RIVET IS A PROPRIETARY ARTICLE MANUFACTURED BY -
AVIATION DEVELOPMENTS LTD, KINGSBOURNE HOUSE, LONDON, WC1, AND KNOWN
COMMERCIALY BY THE MAKERS CODE T.K-SS, T.L-SS, AND THE R.220-SS
SERIES. FOR CALLING UP PURPOSES, HOWEVER, THE A.G.S. NUMBER IS TO
BE USED, FOLLOWED BY THE CODE NUMBER AS GIVEN IN THE TABLE.

LENGTH L INS.	PLATE THICKNESS TO BE RIVETED INS		CODE NUMBERS.					
	FROM	TO						
1/8	—	.064	404	504				
5/32	—	.064			605			
3/16	.064	.125	406	506				
7/32	.064	.125			607	807		
1/4	.125	.188	408	508				
9/32	.125	.188			609	809	1009	
5/16	.188	.250	410	510				
11/32	.188	.250			611	811	1011	1211
3/8	.250	.312		512				
13/32	.250	.312			613	813	1013	1213
7/16	.312	.375		514				
15/32	.312	.375			615	815	1015	1215
17/32	.375	.437			617	817	1017	1217
19/32	.437	.500			619	819	1019	1219
21/32	.500	.562				821	1021	1221
23/32	.562	.625				823	1023	1223
25/32	.625	.687				825	1025	1225
27/32	.687	.750					1027	1227
29/32	.750	.812					1029	1229
31/32	.812	.875						1231
33/32	.875	.937						1238
35/32	.937	1.000						1235
SHANK DIA. INS.	NOMINAL		1/8	5/32	3/16	1/4	5/16	3/8
	ACTUAL		.125 \pm .002	.156 \pm .002	.188 \pm .002	.247 \pm .002	.313 \pm .002	.375 \pm .002
DIA. OF HD. d	\pm .005 INS		.210	.250	.344	.406	.531	.620
DIA. 'B'	INS.		.080 \pm .002	.094 \pm .002	.120 \pm .002	.172 \pm .002	.196 \pm .002	.238 \pm .002
DIA. 'b'	\pm .002" INS.		.060	.074	.098	.146	.169	.205
DEPTH OF HD. t _s	\pm .005 INS		.039	.052	.065	.078	.091	.104
MANDREL HD DIA.	INS.		.088	.107	.132	.184	.210	.250
DRILL SIZE.	INS.		.128	.161	.191	.250	.316	.377

NOTE:- THE LAST TWO FIGURES OF THE CODE NUMBER REPRESENT THE LENGTH IN 1/32"; THE REMAINING FIGURE OR FIGURES, REPRESENTING THE DIA. IN 1/32"

METHOD OF CALLING UP:- THE COMPLETE PART NUMBER FOR THE RIVET IS GIVEN BY QUOTING THE A.G.S. NUMBER, WHICH DEFINES THE TYPE OF RIVET AND THE MATERIAL, FOLLOWED BY THE CODE NUMBER TAKEN FROM THE TABLE ABOVE, WHICH DEFINES THE SHANK DIA. AND LENGTH OF THE RIVET.

EXAMPLE:- A.G.S. 2040/410 IS A CHOBERT RIVET - MILD STEEL WITH SNAP HEAD - 1/8" SHANK DIA. X 5/16" LONG.

NOTE:- RIVETS MAY BE USED WITH, OR WITHOUT SEALING PINS AS REQUIRED. SEALING PINS ARE LISTED ON A.G.S. 2042.

PROTECTIVE TREATMENT:- CADMIUM PLATE, TO SPEC: DTD 904. COLOUR IDENTIFICATION:- CADMIUM

TITLE RIVETS, CHOBERT, STEEL, D.T.D.720, SNAP HEAD. MINISTRY OF SUPPLY APPLICATIONS FOR A.G.S. SHEETS TO - A.T.P.4A. THAMES HOUSE, MILLBANK, S.W.1. GENERAL INQUIRIES TO:- A.D.S.A.E. THAMES HOUSE, MILLBANK, S.W.1.	ISSUE	2	3	3
	ALT. N ^o	878	1001	874
	R.A.E. APPROVAL		A.D.S.A.E. APPROVAL	
	SIGNATURE	DATE	SIGNATURE	DATE
SHEET N ^o	1	A.G.S. N ^o 2040.		
N ^o OF SHEETS	1			

ORIGINAL APPROVAL DATE 13.7.52.