

A.G.S. 2045

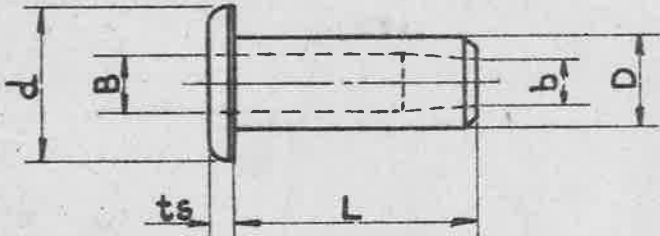

THIS RIVET IS A PROPRIETARY ARTICLE MANUFACTURED BY:-
 AVIATION DEVELOPMENTS LTD
 KINGSBOURNE HOUSE, LONDON. W.C.1.
 AND KNOWN COMMERCIALY BY THE
 MAKER'S CODE TK.-SNA, TL-SNA, AND
 THE R 220-SNA SERIES. FOR CALLING UP
 PURPOSES, HOWEVER, THE A.G.S. NUMBER
 IS TO BE USED, FOLLOWED BY THE
 CODE NUMBER AS GIVEN IN THE TABLE

MANUFACTURING DRAWING No. 15
 RIVET DIA. IN $\frac{1}{32}$ X 100/2.
 L $\frac{1}{8}$ RIVET IS 400/2.

LENGTH L INS.	PLATE THICKNESS TO BE RIVETED INS.		CODE NUMBERS					
	FROM	TO						
1/8		.064	404	504				
5/32		.064			605			
3/16	.064	.125	406	506				
7/32	.064	.125			607	807		
1/4	.125	.188	408	508				
9/32	.125	.188			609	809	1009	
5/16	.188	.250	410	510				
11/32	.188	.250			611	811	1011 1211	
3/8	.250	.312		512				
13/32	.250	.312			613	813	1013 1213	
7/16	.312	.375		514				
15/32	.312	.375			615	815	1015 1215	
17/32	.375	.437			617	817	1017 1217	
19/32	.437	.500			619	819	1019 1219	
21/32	.500	.562				821	1021 1221	
23/32	.562	.625				823	1023 1223	
25/32	.625	.687				825	1025 1225	
27/32	.687	.750					1027 1227	
29/32	.750	.812					1029 1229	
31/32	.812	.875					1231	
33/32	.875	.937					1233	
35/32	.937	1.000					1235	
SHANK DIA. 'D' INS.	NOMINAL		1/8	5/32	3/16	1/4	5/16	3/8
	ACTUAL		.125 ± .002	.156 ± .002	.188 ± .002	.247 ± .002	.313 ± .002	.375 ± .002
DIA. OF HD. 'd' ± .005	INS.		.210	.250	.344	.406	.531	.620
DIA. 'B'	INS.		.080 ± .002	.094 ± .002	.120 ± .002	.172 ± .002	.196 ± .002	.238 ± .002
DIA. 'b' ± .002	INS.		.060	.074	.098	.146	.169	.205
DEPTH OF HD. 'ts' ± .005	INS.		.039	.052	.065	.078	.091	.104
MANDREL HD. DIA.	INS.		.088	.107	.132	.184	.210	.250
DRILL SIZE	INS.		.128	.161	.191	.250	.316	.377

NOTE:- THE LAST TWO FIGURES OF THE CODE NUMBER REPRESENT THE LENGTH IN $\frac{1}{32}$ THE REMAINING FIGURE OR FIGURES REPRESENTING THE DIA. IN $\frac{1}{32}$.

METHOD OF CALLING UP:- THE COMPLETE PART NUMBER FOR THE RIVET IS GIVEN BY QUOTING THE A.G.S. NUMBER, WHICH DEFINES THE TYPE OF RIVET AND THE MATERIAL, FOLLOWED BY THE CODE NUMBER, TAKEN FROM THE TABLE ABOVE, WHICH DEFINES THE SHANK DIA, AND LENGTH OF THE RIVET.

EXAMPLE:- A.G.S. 2045/410 IS A CHOBERT RIVET-ALUM^m ALLOY WITH SNAPHEAD - $\frac{1}{8}$ " SHANK DIA X $\frac{5}{16}$ " LONG.

NOTE:- RIVETS MAY BE USED WITH, OR WITHOUT, SEALING PINS (AS REQUIRED).
 SEALING PINS ARE LISTED ON A.G.S. 2047.
 SEALING PIN IN L.I. OR D.T.D. 423, IS USED WITH L.57 RIVET.

IDENTIFICATION TREATMENT:- ANODISE TO SPEC. D.T.D. 910, FOLLOWED BY DYEING OR TREAT IN ACCORDANCE WITH D.T.D. 913. COLOUR IDENTIFICATION:- VIOLET.

SM 597

**TITLE:- RIVETS, CHOBERT, -
 ALUM. ALLOY L.57. SNAP HEAD.**

ISSUE	2				
ALT. NO	MOD/AGS 878				

MINISTRY OF SUPPLY
 APPLICATIONS FOR A.G.S. SHEETS TO:-
 ATP.4A. THAMES HOUSE, MILLBANK, S.W.1.

R.A.E. APPROVAL		AD. S.A.E. APPROVAL	
SIGNATURE	DATE	SIGNATURE	DATE
<i>C.S. R...</i>	4-1-52	<i>G.T. Y...</i>	6/6/52

GENERAL INQUIRIES TO:-
 AD. S.A.E. THAMES HOUSE, MILLBANK, S.W.1.

SHEET NO	1	A.G.S. No 2045
NO OF SHEETS	1	

ON RIVET CODE NO 304 ONLY, BORE IS A CONTINUOUS TAPER OVER THE WHOLE LENGTH.

A.G.S. 2045 SHEET 1

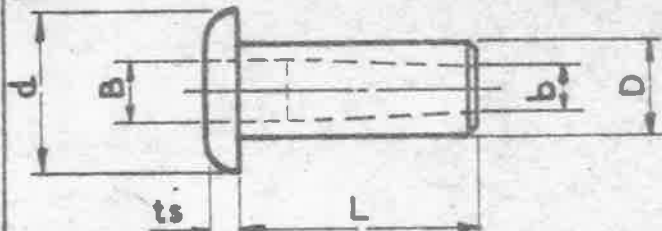

MANUFACTURING DRAWING NO IS RIVET DIA. IN 1/32" X 100/2
I.e. 1/8" RIVET IS 400/2.

THIS RIVET IS A PROPRIETARY ARTICLE MANUFACTURED BY:- AVIATION DEVELOPMENTS LTD, KINGSBOURNE HOUSE, LONDON W.C.1. AND KNOWN COMMERCIALY BY THE MAKERS CODE TJ-SNA, TK-SNA, TL-SNA AND THE R220-SNA SERIES. FOR CALLING UP PURPOSES, HOWEVER, THE A.G.S. NUMBER IS TO BE USED, FOLLOWED BY THE CODE NUMBER AS GIVEN IN THE TABLE.

LENGTH L INS.	PLATE THICKNESS TO BE RIVETED INS		CODE NUMBERS						
	FROM	TO							
1/8		.064	304	404	504				
5/32		.064				605			
3/16	.064	.125	306	406	506				
7/32	.064	.125				607	807		
1/4	.125	.188	308	408	508				
9/32	.125	.188				609	809	1009	
5/16	.188	.250	310	410	510				
11/32	.188	.250				611	811	1011	1211
3/8	.250	.312			512				
13/32	.250	.312				613	813	1013	1213
7/16	.312	.375			514				
15/32	.312	.375				615	815	1015	1215
17/32	.375	.437				617	817	1017	1217
19/32	.437	.500				619	819	1019	1219
21/32	.500	.562					821	1021	1221
23/32	.562	.625					823	1023	1223
25/32	.625	.687					825	1025	1225
27/32	.687	.750						1027	1227
29/32	.750	.812						1029	1229
31/32	.812	.875							1231
33/32	.875	.937							1233
35/32	.937	1.000							1235
SHANK DIA. 'D' INS.	NOMINAL		3/32	1/8	5/32	3/16	1/4	5/16	3/8
	ACTUAL		.094 ^{±.002}	.125 ^{±.002}	.156 ^{±.002}	.188 ^{±.002}	.247 ^{±.002}	.313 ^{±.002}	.375 ^{±.002}
DIA. OF HD. 'd'	±.005	INS.	.156	.210	.250	.344	.406	.531	.620
DIA. 'B'		INS.	.064 ^{±.002}	.080 ^{±.002}	.094 ^{±.002}	.120 ^{±.002}	.172 ^{±.002}	.196 ^{±.002}	.238 ^{±.002}
DIA. 'b'	±.002	INS.	.054	.060	.074	.098	.146	.169	.205
DEPTH OF HD. 'ts'	±.005	INS.	.031	.039	.052	.065	.078	.091	.104
MANDREL HD. DIA.		INS.	.0725	.088	.107	.132	.184	.210	.250
DRILL SIZE		INS.	.096	.128	.161	.191	.250	.316	.377

NOTE:- THE LAST TWO FIGURES OF THE CODE NUMBER REPRESENT THE LENGTH IN 1/32" THE REMAINING FIGURE OR FIGURES REPRESENTING THE DIA. IN 1/32".

METHOD OF CALLING UP:- THE COMPLETE PART NUMBER FOR THE RIVET IS GIVEN BY QUOTING THE A.G.S. NUMBER, WHICH DEFINES THE TYPE OF RIVET AND THE MATERIAL, FOLLOWED BY THE CODE NUMBER, TAKEN FROM THE TABLE ABOVE, WHICH DEFINES THE SHANK DIA. AND LENGTH OF THE RIVET.

EXAMPLE:- A.G.S. 2045/410 IS A CHOBERT RIVET-ALUMI ALLOY WITH SNAP HEAD - 1/8" SHANK DIA. X 5/16" LONG.

NOTE:- RIVETS MAY BE USED WITH, OR WITHOUT, SEALING PINS (AS REQUIRED) SEALING PINS ARE LISTED ON A.G.S. 2047. SEALING PIN IN L.64 OR D.T.D. 423, IS USED WITH L.69 RIVET.

IDENTIFICATION TREATMENT:- ANODISE TO SPEC. D.T.D. 910, FOLLOWED BY DYEING OR TREAT IN ACCORDANCE WITH D.T.D. 913. COLOUR IDENTIFICATION:- VIOLET.

TITLE	RIVETS, CHOBERT,	ISSUE	5/38/57				
	ALUMI ALLOY L.69 SNAP HEAD	ALT. NO.	M00/AGS 991				
MINISTRY OF SUPPLY APPLICATIONS FOR A.G.S. SHEETS TO:- A.T.P.4, BLOCK 'E', CHESSINGTON, SURREY. GENERAL ENQUIRIES TO:- A.D.S.A.E. ST. GILES COURT, 1-13 ST. GILES HIGH STREET, LONDON W.C.2.	R.A.E. APPROVAL		NUMBER OF SHEETS	A.G.S. NO. 2045 SHEET 1			
	SIGNATURE	DATE					
	A.D.S.A.E. APPROVAL		1				
	SIGNATURE	DATE					

ORIGINAL APPROVAL DATE 13.7.50