

THIS RIVET IS A PROPRIETARY ARTICLE MANUFACTURED BY:- AVIATION DEVELOPMENTS LTD, KINGSBOURNE HOUSE, LONDON, W.C.1. AND KNOWN COMMERCIALY BY THE MAKER'S CODE T.K.- C.N.A., T. L - C.N.A AND THE R.220-C.N.A. SERIES. FOR CALLING UP PURPOSES, HOWEVER, THE A.G.S. NUMBER IS TO BE USED, FOLLOWED BY THE CODE NUMBER AS GIVEN IN THE TABLE.

MANUFACTURING DRAWING NO. IS RIVET DIA. IN 1/32 X 100/22. I.E. 1/8 RIVET IS 400/22.

LENGTH L INS.	PLATE THICKNESS TO BE RIVETED, INS.		CODE NUMBERS					
	FROM	TO						
1/8	-	.064	404	504				
5/32	-	.064			605			
3/16	.064	.125	406	506				
7/32	.064	.125			607	807		
1/4	.125	.188	408	508				
9/32	.125	.188			609	809	1009	
5/16	.188	.250	410	510				
11/32	.188	.250			611	811	1011	1211
3/8	.250	.312		512				
13/32	.250	.312			613	813	1013	1213
7/16	.312	.375		514				
15/32	.312	.375			615	815	1015	1215
17/32	.375	.437			617	817	1017	1217
19/32	.437	.500			619	819	1019	1219
21/32	.500	.562				821	1021	1221
23/32	.562	.625				823	1023	1223
25/32	.625	.687				825	1025	1225
27/32	.687	.750					1027	1227
29/32	.750	.812					1029	1229
31/32	.812	.875						1231
33/32	.875	.937						1233
35/32	.937	1.000						1235
SHANK DIA. 'D' INS.	NOMINAL		1/8	5/32	3/16	1/4	5/16	3/8
	ACTUAL		.125 ± .002	.156 ± .002	.188 ± .002	.247 ± .002	.313 ± .002	.375 ± .002
DIA. OF HD. 'd' ± .005 INS.			.210	.250	.344	.406	.531	.620
DIA. 'B' INS.			.080 ± .002	.094 ± .002	.120 ± .002	.172 ± .002	.196 ± .002	.238 ± .002
DIA. 'b' ± .002 INS.			.060	.074	.098	.146	.169	.205
DEPTH OF HD 'tc' ± .003 INS.			.030	.032	.050	.051	.068	.081
MANDREL HD. DIA. INS.			.088	.107	.132	.184	.210	.250
DRILL SIZE			.128	.161	.191	.250	.316	.377

NOTE:- THE LAST TWO FIGURES OF THE CODE NUMBER REPRESENT THE LENGTH IN 1/32, THE REMAINING FIGURE OR FIGURES REPRESENTING THE DIA IN 1/32.

METHOD OF CALLING UP:- THE COMPLETE PART NUMBER FOR THE RIVET IS GIVEN BY QUOTING THE A.G.S. NUMBER, WHICH DEFINES THE TYPE OF RIVET AND THE MATERIAL, FOLLOWED BY THE CODE NUMBER TAKEN FROM THE TABLE ABOVE, WHICH DEFINES THE SHANK DIA. AND LENGTH OF THE RIVET.

EXAMPLE:- A.G.S. 2046/410 IS A CHOBERT RIVET-ALUM<sup>N</sup> ALLOY WITH C'SK. HD. - 1/8" SHANK DIA. X 5/16" LONG.

NOTE:- RIVETS MAY BE USED WITH, OR WITHOUT, SEALING PINS (AS REQUIRED). SEALING PINS ARE LISTED ON A.G.S. 2047. SEALING PIN IN L.1 OR D.T.D. 423, IS USED WITH L.57 RIVET.

IDENTIFICATION TREATMENT:- ANODISE TO SPEC:- D.T.D. 910, FOLLOWED BY DYEING OR TREAT IN ACCORDANCE WITH D.T.D. 913, COLOUR IDENTIFICATION:- VIOLET.

TITLE RIVETS, CHOBERT, ALUM <sup>N</sup> ALLOY. L 57, C'SK. HEAD.	ISSUE	SM 2597					
	ALT. NO.	MOD A45 878					
MINISTRY OF SUPPLY APPLICATIONS FOR A.G.S. SHEETS TO: A.T.P.4A. THAMES HOUSE, MILLBANK, S.W.1.	R.A.E. APPROVAL		A.D. S.A.E. APPROVAL				
	SIGNATURE	DATE	SIGNATURE	DATE			
GENERAL INQUIRIES TO:- A.D.S.A.E. THAMES HOUSE, MILLBANK, S.W.1.	SHEET NO 1		A.G.S. NO 2046		C.T. Painter 6/6/52		
	NO OF SHEETS 1						

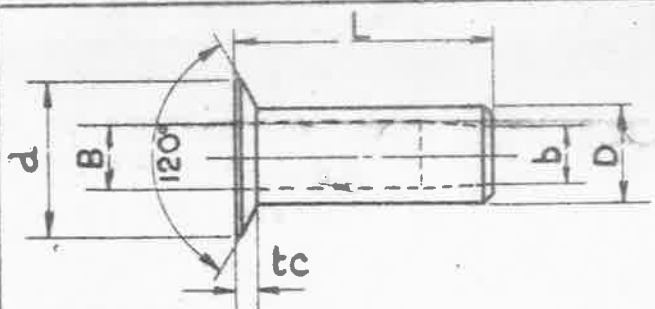

THIS RIVET IS A PROPRIETARY ARTICLE MANUFACTURED BY:- AVIATION DEVELOPMENTS LTD, KINGSBOURNE HOUSE, LONDON, W.C.1, AND KNOWN COMMERCIALY BY THE MAKERS CODE TK.-C.N.A., T.L.-C.N.A AND THE R.220-C.N.A. SERIES. FOR CALLING UP PURPOSES, HOWEVER, THE A.G.S. NUMBER IS TO BE USED, FOLLOWED BY THE CODE NUMBER AS GIVEN IN THE TABLE.

MANUFACTURING DRAWING NO. 15  
RIVET DIA. IN 1/32 X 100/22.  
tc. 1/8 RIVET IS 400/22.

LENGTH L INS.	PLATE THICKNESS TO BE RIVETED, INS.		CODE NUMBERS					
	FROM	TO						
1/8	-	.064	404	504				
5/32	-	.064			605			
3/16	.064	.125	406	506				
7/32	.064	.125			607	807		
1/4	.125	.188	408	508				
9/32	.125	.188			609	809	1009	
5/16	.188	.250	410	510				
11/32	.188	.250			611	811	1011	1211
3/8	.250	.312		512				
13/32	.250	.312			613	813	1013	1213
7/16	.312	.375		514				
15/32	.312	.375			615	815	1015	1215
17/32	.375	.437			617	817	1017	1217
19/32	.437	.500			619	819	1019	1219
21/32	.500	.562				821	1021	1221
23/32	.562	.625				823	1023	1223
25/32	.625	.687				825	1025	1225
27/32	.687	.750					1027	1227
29/32	.750	.812					1029	1229
31/32	.812	.875						1231
33/32	.875	.937						1233
35/32	.937	1.000						1235
SHANK DIA. 'D' INS.	NOMINAL		1/8	5/32	3/16	1/4	5/16	3/8
	ACTUAL		.125 ± .002	.156 ± .002	.188 ± .002	.247 ± .002	.313 ± .002	.375 ± .002
DIA. OF HD. 'd' ± .005 INS.			.210	.250	.344	.406	.531	.620
DIA. 'B' INS.			.080 ± .002	.094 ± .002	.120 ± .002	.172 ± .002	.196 ± .002	.238 ± .002
DIA. 'b' ± .002 INS.			.060	.074	.098	.146	.169	.205
DEPTH OF HD. 'tc' ± .003 INS.			.030	.032	.050	.051	.068	.081
MANDREL HD. DIA. INS.			.088	.107	.132	.184	.210	.250
DRILL SIZE			.128	.161	.191	.250	.316	.377

NOTE:- THE LAST TWO FIGURES OF THE CODE NUMBER REPRESENT THE LENGTH IN 1/32, THE REMAINING FIGURE OR FIGURES REPRESENTING THE DIA IN 1/32.

METHOD OF CALLING UP:- THE COMPLETE PART NUMBER FOR THE RIVET IS GIVEN BY QUOTING THE A.G.S. NUMBER, WHICH DEFINES THE TYPE OF RIVET AND THE MATERIAL, FOLLOWED BY THE CODE NUMBER TAKEN FROM THE TABLE ABOVE, WHICH DEFINES THE SHANK DIA. AND LENGTH OF THE RIVET.

EXAMPLE:- A.G.S. 2046/410 IS A CHOBERT RIVET-ALUM<sup>N</sup> ALLOY WITH C'SK. HD. -1/8" SHANK DIA. X 5/16" LONG.

NOTE:- RIVETS MAY BE USED WITH, OR WITHOUT, SEALING PINS (AS REQUIRED). SEALING PINS ARE LISTED ON A.G.S. 2047. SEALING PIN IN L.64 OR D.T.D. 423, IS USED WITH L.69 RIVET.

IDENTIFICATION TREATMENT:- ANODISE TO SPEC.-D.T.D. 910, FOLLOWED BY DYEING OR TREAT IN ACCORDANCE WITH D.T.D. 913, COLOUR IDENTIFICATION:-VIOLET.

TITLE RIVETS, CHOBERT, ALUM <sup>N</sup> ALLOY. L.69, C'SK. HEAD.  MINISTRY OF SUPPLY APPLICATIONS FOR A.G.S. SHEETS TO ATP.4A. THAMES HOUSE, MILLBANK, SW1. GENERAL INQUIRIES TO - AD SAE THAMES HOUSE, MILLBANK SW1	ISSUE	2	303069
	ALT N <sup>o</sup>	MOD A G S	MOD A C S
		878	991
	R.A.E. APPROVAL	AD SAE APPROVAL	
SIGNATURE	DATE	SIGNATURE	DATE
<i>C.B. R...</i>	4.1.52	<i>C.T. Tain...</i>	6/6/52
SHEET NO	1	A.G.S. NO 2046	
NO OF SHEETS	1		