

BASED ON MANUFACTURER'S
DRAWING NO. G.T. 30126 B
SHEETS 1 & 2.

IMPORTANT NOTE.
FOR PRECAUTIONS RE
USE - SEE A.P. 970
LEAFLET 405/2.

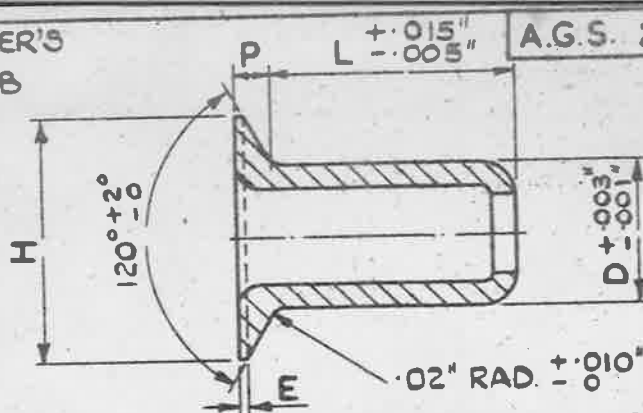

THIS RIVET IS A PROPRIETARY ARTICLE MANUFACTURED BY:- GEORGE TUCKER EYELET
CO. LTD. WALGALL ROAD, BIRMINGHAM, AND KNOWN COMMERCIALY BY THE MAKER'S
CODE LETTERS T.L.P/K. FOR CALLING UP PURPOSES, HOWEVER, THE A.G.S. NUMBER IS
TO BE USED, FOLLOWED BY THE CODE NUMBER AS GIVEN IN THE TABLE.

LENGTH L. INS.	MAX. THICKNESS * TO BE RIVETED INS.		CODE NUMBERS.			
	BREAK HEAD	BREAK STEM				
.13	.08	-		413		
.19	.11	.09	319			
.19	.12	.10		419		
.19	.11	.08			519	
.21	.13	.11	321			
.24	.17	.15		424		
.24	.17	.13			524	
.24	.15	.12				624
.29	.22	.20		429		
.30	.23	.19			530	
.30	.20	.18				630
.35	.28	.26		435		
.36	.26	.23				636
.37	.28	.26			537	
.39	.28	.26				639
.40	.33	.31		440		
.40	.32	.29			540	
.45	.37	.34			545	
.50	.39	.37				650
.65	.54	.52				665
.75	.64	.62				675
SHANK DIA. 'D' INS.			7/64	1/8	5/32	3/16
DIA. OF HEAD 'H' INS.			.192 ± .007	.236 ± .007	.263 ± .007	.307 ± .007
DEPTH OF HEAD 'P' INS.			.028 ± .003	.036 ± .003	.039 ± .003	.045 ± .003
EDGE 'E' INS.			.006 ± .003	.008 ± .005	.008 ± .005	.010 ± .005
DRILL SIZE			.1130	.1285	.1610	.1910

NOTE:- THE FIRST FIGURE OF THE CODE NUMBER REPRESENTS THE DIA. E.G. 3 = 7/64, 4 = 1/8, 5 = 5/32, & 6 = 3/16. THE LENGTH IN 1/100" IS INDICATED BY THE LAST TWO FIGURES.
METHOD OF CALLING UP:- THE COMPLETE PART NUMBER FOR THE RIVET IS GIVEN BY QUOTING THE A.G.S. NUMBER, WHICH DEFINES THE TYPE OF RIVET AND THE MATERIAL, FOLLOWED BY THE CODE NUMBER, TAKEN FROM THE TABLE ABOVE, WHICH DEFINES THE SHANK DIA. AND LENGTH OF THE RIVET.
EXAMPLE:- A.G.S. 2051/424 IS A TUCKER 'POP' RIVET - MONEL WITH C'SK. HEAD. - 1/8 SHANK DIA. X .24" LONG. ADD B.S. OR B.H. TO THIS PART NUMBER TO INDICATE BREAK STEM, OR BREAK HEAD, MANDREL.
PROTECTIVE TREATMENT:- CADMIUM PLATE TO SPEC: D.T.D. 904. (LATEST ISSUE.)
COLOUR IDENTIFICATION:- CADMIUM.
* THIS APPLIES WHERE THE PLATES HAVE BEEN C'SK. BY MACHINING AND NOT DIMPLING

TITLE RIVETS, TUCKER, MONEL	ISSUE	5m 2					
D.T.D. IOB. 'POP' C'SK. HEAD.	ALT. NO.	MOD/AGS 919					
MINISTRY OF SUPPLY APPLICATIONS FOR A.G.S. SHEETS TO:- AT.P.4. BLOCK 'E' CHESSINGTON, SURREY. GENERAL ENQUIRIES TO:- A.D./S.A.E. ST. GILES COURT, 1-13 ST. GILES HIGH STREET, LONDON W.C.2.	R.A.E. APPROVAL		NUMBER OF SHEETS		A.G.S. No. 2051 SHEET 1		
	SIGNATURE	DATE	1				
	A.D.S.A.E. APPROVAL						
	SIGNATURE	DATE					
	G.T. Fountain		20/8/53				

ORIGINAL APPROVAL DATE 13.7.50

A.G.S. 2051

ISSUED BY THE SOCIETY OF BRITISH AIRCRAFT CONSTRUCTORS LTD.,
28, KING STREET, ST. JAMES, LONDON, S.W.1.

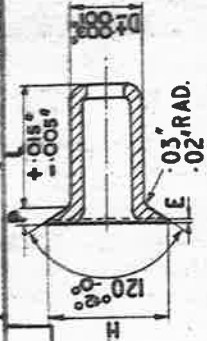

FOR PRECAUTIONS RE USE - SEE A.P.970
LEAFLET 405/2

NOTE:-

THE FIRST FIGURE OF THE CODE NUMBER REPRESENTS THE DIA. E. G. $3 = \frac{3}{16}$, $4 = \frac{1}{8}$, $5 = \frac{5}{32}$ & $6 = \frac{3}{16}$. THE LENGTH IN $\frac{1}{100}$ " IS INDICATED BY THE LAST TWO FIGURES.

METHOD OF CALLING UP:-

THE COMPLETE PART NUMBER FOR THE RIVET IS GIVEN BY QUOTING THE A.G.S. NUMBER, WHICH DEFINES THE TYPE OF RIVET AND THE MATERIAL, FOLLOWED BY THE CODE NUMBER, TAKEN FROM THE TABLE, WHICH DEFINES THE SHANK DIA. AND LENGTH OF THE RIVET

EXAMPLE:-

A.G.S.2051/424 IS A TUCKER 'POP' RIVET-MONEL WITH C'SK. HEAD $\frac{1}{8}$ " SHANK DIA. X 24" LONG. ADD B.S. OR B.H. TO THIS PART NUMBER TO INDICATE BREAK STEM, OR BREAK HEAD MANDREL.

PROTECTIVE TREATMENT.

CADMIUM PLATE TO SPEC. D.T.D. 904.

COLOUR IDENTIFICATION: PLAIN.

THIS APPLIES WHERE THE PLATES HAVE BEEN C'SK. BY MACHINING AND NOT DIMPLING.

LENGTH 'L' INS.	MAXIMUM THICKNESS TO BE RIVETED INS.		CODE NUMBERS	
	BREAK HEAD	BREAK STEM		
.13	.08	-	413	
.19	.11	.09	319	
.19	.12	.10	419	
.19	.11	.08		519
.21	.13	.11	321	
.24	.17	.15	424	
.24	.17	.13		524
.24	.15	.12		624
.29	.22	.20	429	
.30	.23	.19		530
.30	.20	.18		630
.35	.28	.26	435	
.36	.26	.23		636
.37	.28	.26		537
.39	.28	.26		639
.40	.33	.31	440	
.40	.32	.29		540
.45	.37	.34		645
.50	-	.53		850
.50	.39	.37		650
.65	.54	.52		665
.70	-	.53		870
.75	.64	.62		675
SHANK DIA.		'D' INS.	7/64	5/32
DIA. OF HEAD		'H' INS.	.199/.185	.243/.229
DEPTH OF HEAD		'P' INS.	.031/.025	.039/.033
EDGE		'E' INS.	.009/.003	.013/.003
DRILL SIZE		INS.	.1130	.1285
				.1610
				.1910
				.2570

REF.	DRAWING OR PART No.	MONEL	D.T.D. IO. B.
PT	SEE ABOVE	SCALE	MATERIAL REMARKS
HT	RIVETS, TUCKER, MONEL 'POP'	LIMITS NOT SHOWN	UNIT QTY
	C'SK. HEAD		
			A.G.S. 2051

DESIGNED	DRAWN	TRACED	CHECKED	APPROVED FOR	DATE
TUCKER	F.A.C.	F.A.C.	F.A.C.	K. J. J. J.	16.5.55
ISSUED BY THE SOCIETY OF BRITISH AIRCRAFT CONSTRUCTORS LTD.,					
28, KING STREET, ST. JAMES, LONDON, S.W.1.					