

BASED ON MANUFACTURER'S  
DRAWING NO G.T.30130B.  
SHEETS 1 & 2.

A.G.S. 2056 SHEET 1

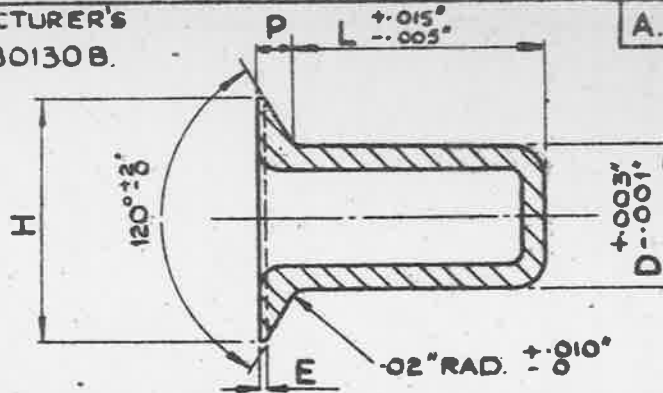

THIS RIVET IS A PROPRIETARY ARTICLE MANUFACTURED BY:- GEORGE TUCKER EYELET CO. LTD. WALSALL ROAD, BIRMINGHAM, AND KNOWN COMMERCIALY BY THE MAKER'S CODE LETTERS T.L.C./K. FOR CALLING UP PURPOSES, HOWEVER, THE A.G.S. NUMBER IS TO BE USED, FOLLOWED BY THE CODE NUMBER AS GIVEN IN THE TABLE.

LENGTH L INS.	MAX. * THICKNESS TO BE RIVETED. INS	CODE NUMBERS.			
.14	.08		414		
.20	.11	320			
.20	.12		420		
.20	.11			520	
.22	.13	322			
.25	.17		425		
.25	.17			525	
.25	.15				625
.30	.22		430		
.31	.23			531	
.31	.20				631
.36	.28		436		
.37	.26				637
.38	.28			538	
.40	.28				640
.41	.33		441		
.41	.32			541	
.46	.37			546	
.51	.39				651
.66	.54				666
.76	.64				676
SHANK DIA.	D' INS.	7/64	1/8	5/32	3/16
DIA. OF HEAD	H' INS.	.192 ± .007	.236 ± .007	.263 ± .007	.320 ± .010
DEPTH OF HEAD	P' INS.	.028 ± .003	.036 ± .003	.039 ± .003	.045 ± .006
EDGE	E' INS.	.006 ± .003	.008 ± .005	.008 ± .005	.010 ± .008
DRILL SIZE	INS.	.1130	.1285	.1610	.1910

NOTE :- THE FIRST FIGURE OF THE CODE NUMBER REPRESENTS THE DIA. e.g. 3-7/64", 4-1/8", 5-5/32", & 6-3/16". THE LENGTH IN 1/100" IS INDICATED BY THE LAST TWO FIGURES.

METHOD OF CALLING UP:- THE COMPLETE PART NUMBER FOR THE RIVET IS GIVEN BY QUOTING THE A.G.S. NUMBER, WHICH DEFINES THE TYPE OF RIVET AND THE MATERIAL, FOLLOWED BY THE CODE NUMBER, TAKEN FROM THE TABLE ABOVE, WHICH DEFINES THE SHANK DIA. AND LENGTH OF THE RIVET.

EXAMPLE:- A.G.S. 2056/425 IS A TUCKER CUP RIVET - MONEL WITH C'SK. HEAD - 1/8" SHANK DIA. x .25" LONG.

PROTECTIVE TREATMENT:- CADMIUM PLATE TO SPEC: DTD 904. (LATEST ISSUE)

COLOUR IDENTIFICATION:- CADMIUM.

\* THIS APPLIES WHERE THE PLATES HAVE BEEN C'SK. BY MACHINING AND NOT DIMPLING.

TITLE	RIVETS, TUCKER, MONEL	ISSUE	5/2 439					
	D.T.D.I.O.B. CUP, C'SK. HEAD.	ALT. NO.	919					
MINISTRY OF SUPPLY APPLICATIONS FOR A.G.S. SHEETS TO:- A.T.P.4, BLOCK 'E', CHESSINGTON, SURREY. GENERAL ENQUIRIES TO:- A.D./S.A.E. ST. GILES COURT, 1-13 ST. GILES HIGH STREET, LONDON W.C.2.	R.A.E. APPROVAL		NUMBER OF SHEETS		A.G.S. NO. 2056 SHEET 1			
	SIGNATURE	DATE	1					
	A.D./S.A.E. APPROVAL							
	SIGNATURE	DATE						

ORIGINAL APPROVAL DATE 13.7.50.