

A. G. S. 2070

G. A. F.
SR551. 10.5.61

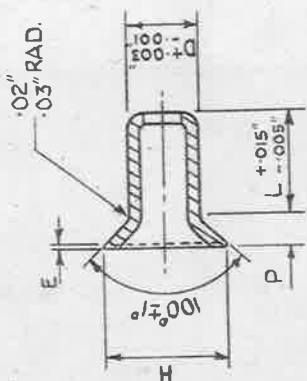

FOR PRECAUTIONS RE. USE SEE A.P.970 LEAFLET 405/2.

NOTE:-

THE FIRST FIGURE OF THE CODE NUMBER REPRESENTS THE DIA. E.G. 4=1/8", 5=5/32", 6=3/16". THE LENGTH IN 1/100" IS INDICATED BY THE LAST TWO FIGURES.

METHOD OF CALL UP:-

THE COMPLETE PART NUMBER FOR THE RIVET IS GIVEN BY QUOTING THE A.G.S. NUMBER, WHICH DEFINES THE TYPE OF RIVET AND THE MATERIAL, FOLLOWED BY THE CODE NUMBER, TAKEN FROM THE TABLE, WHICH DEFINES THE SHANK DIA. AND THE LENGTH OF THE RIVET.

EXAMPLE:-

AGS. 2070/524 - IS A 100° TUCKER 'POP' RIVET - MONEL WITH C'SK. HEAD - 5/32" SHANK DIA. X .24" LONG. ADD B.S. OR B.H. TO THIS PART NUMBER TO INDICATE BREAK STEM OR BREAK HEAD MANDREL.

PROTECTIVE TREATMENT:-

CADMIUM PLATE.
MANDREL, DYED BLUE.
(FOR UNPLATED RIVETS SEE A.G.S. 2071.)

LENGTH 'L' INS.	MAX. THICKNESS * TO BE RIVETED INS.		CODE NUMBERS
	BREAK HEAD	BREAK STEM.	
.19	.12	.10	419
.24	.17	.13	524
.29	.22	.20	429
.30	.20	.18	630
.37	.28	.26	537
.39	.28	.26	
.40	.33	.31	440
.45	.37	.34	545
.50	.39	.37	650
SHANK DIA.	D' INS.		1/8
DIA. OF HEAD.	H' INS.		.222/.208
DEPTH OF HEAD.	P' INS.		.045/.039
EDGE.	E' INS.		.014/.004
DRILL SIZE.	INS.		.1285
			5/32
			.281/.267
			.076/.064
			.015/.005
			.020/.004
			.1910

* THIS APPLIES WHERE THE PLATES HAVE BEEN C'SK. BY MACHINING AND NOT DIMPLING.

ISSUE NO.	ISSUED BY	DATE	DESIGNED	DRAWN	TRACED	CHECKED	HT	PT SEE ABOVE	SCALE	DESCRIPTION	LIMITS NOT SHOWN	UNIT QTY.	MATERIAL-REMARKS
	TUCKER	18.5.53	TUCKER	F.A.C.				RIVETS, TUCKER. 100° MONEL 'POP'		MONEL			D.T.D. 10 B.
								C'SK. HEAD. (PLATED).					A.G.S. 2070

ISSUED BY THE SOCIETY OF BRITISH AIRCRAFT CONSTRUCTORS LTD,
29 KING STREET, ST. JAMES'S, LONDON S.W.1.

CAF RELEASE
DATE: 30-1-73

AGS. 2070.		AGS. 2070.		AGS. 2070.		AGS. 2070.		AGS. 2070.		AGS. 2070.		AGS. 2070.		AGS. 2070.	
USED ON		HT		SCALE		LIMITS NOT SHOWN		DESCRIPTION		MATERIAL—REMARKS		D.T.D. 10 B.		MATERIAL—REMARKS	
DESIGNED BY TUCKER.		DRAWN BY E.A.C.		CHECKED BY E.A.C.		DATE 16-5-57		PT SEE ABOVE RIVETS: TUCKER. 100° MONEL 'POP' C'SK. HEAD (PLATED).		D.T.D. 10 B.		AGS. 2070.		AGS. 2070.	
ISSUED BY THE SOCIETY OF BRITISH AIRCRAFT CONSTRUCTORS LTD., 29, KING STREET, ST. JAMES'S, LONDON, S.W.1.		DESIGNED BY TUCKER.		DRAWN BY E.A.C.		CHECKED BY E.A.C.		DATE 16-5-57		PT SEE ABOVE RIVETS: TUCKER. 100° MONEL 'POP' C'SK. HEAD (PLATED).		D.T.D. 10 B.		AGS. 2070.	

LENGTH L INS.	MAX. THICKNESS * TO BE RIVETED INS.		CODE NUMBERS.	
	BREAK HEAD.	BREAK STEM.		
.19	.12	.10	419	
.24	.17	.13	524	
.29	.22	.20	429	
.30	.20	.18	630	
.37	.28	.26	537	
.39	.28	.26	639	
.40	.33	.31	440	
.45	.37	.34	545	
.50	.39	.37	650	
SHANK DIA.	'D' INS.		1/8	5/32
DIA. OF HEAD.	'H' INS.		.222/.208	.281/.267
DEPTH OF HEAD.	'P' INS.		.045/.039	.058/.052
EDGE.	'E' INS.		.014/.004	.015/.005
DRILL SIZE.	INS.		.1285	.1610
				.1910

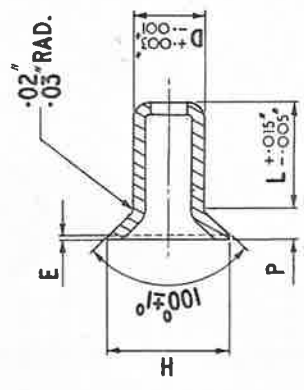

FOR PRECAUTIONS RE. USE SEE A.P. 970 LEAFLET 405/2.

NOTE:-

THE FIRST FIGURE OF THE CODE NUMBER REPRESENTS THE DIA. E.G. 4-1/8, 5-5/32, 6-3/16. THE LENGTH IN 1/100" IS INDICATED BY THE LAST TWO FIGURES.

METHOD OF CALL UP:-

THE COMPLETE PART NUMBER FOR THE RIVET IS GIVEN BY QUOTING THE A.G.S. NUMBER, WHICH DEFINES THE TYPE OF RIVET AND THE MATERIAL, FOLLOWED BY THE CODE NUMBER, TAKEN FROM THE TABLE, WHICH DEFINES THE SHANK DIA. AND THE LENGTH OF THE RIVET.

EXAMPLE:-

AGS. 2070/524 - IS A 100° TUCKER 'POP' RIVET - MONEL WITH C'SK. HEAD - 5/32" SHANK DIA. X .24" LONG. ADD B.S. OR B.H. TO THIS PART NUMBER TO INDICATE BREAK STEM OR BREAK HEAD MANDREL.

PROTECTIVE TREATMENT:-

CADMIUM PLATE.
MANDREL, DYED BLUE.
(FOR UNPLATED RIVETS SEE A.G.S. 2071.)

* THIS APPLIES WHERE THE PLATES HAVE BEEN C'SK. BY MACHINING AND NOT DIMPLING.