

SEE A.G.S. 100 FOR GENERAL INFORMATION.

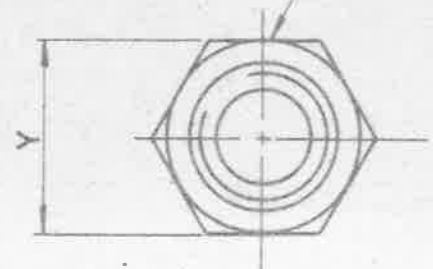

ALL SHARP EDGES AND BURRS TO BE REMOVED.

MACHINE ALL OVER.

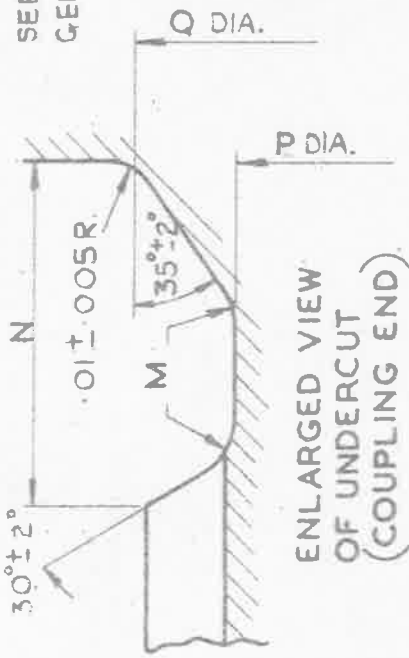

ALL DIMENSIONS ARE IN INCHES.

SMOOTH FINISH FREE FROM VISIBLE TOOL MARKS.

30°±2° CHAMFER TO ROOT OF THREAD.

COUPLING END.

COMPONENT END.

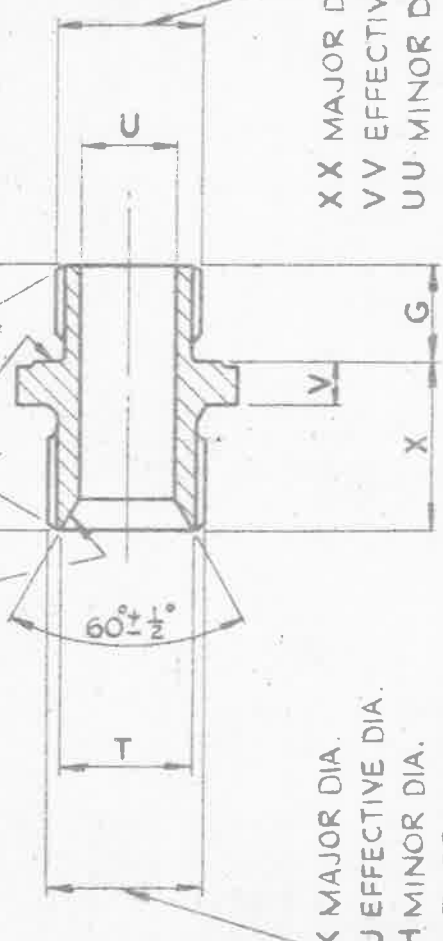

K MAJOR DIA.
J EFFECTIVE DIA.
H MINOR DIA.
L THREADS PER INCH.

X X MAJOR DIA.
V V EFFECTIVE DIA.
U U MINOR DIA.
Y Y THREADS PER INCH.

5R478

MATERIAL :- NON-CORR. STEEL TO SPEC. D.T.D. 525 (LATEST ISSUE)

NOTE :- B.S.P. THREADS TO BE IN ACCORDANCE WITH BS SPEC. N° 84 (LATEST ISSUE) MEDIUM FIT, TRUNCATED U.N. THREADS TO BE IN ACCORDANCE WITH B.S. SPEC. N° 1580 (LATEST ISSUE) CLASS 2A FIT.

TITLE :- PIPE COUPLINGS (STEEL)-UNION ADAPTOR / UNIFIED ATTACHMENT END, 3/16 TO 1/2 - FOR USE WITH "O" RING GASKETS, IN AMERICAN (AND 10050) OR EQUIVALENT A.G.S. 3018 TAPPED BOSSES.		ISSUE	1			
		ALT. N°	MOD/AGS 1018			
R & E APPROVAL SIGNATURE: <i>[Signature]</i> DATE: 25.9.56 A.D.S.A.E APPROVAL SIGNATURE: <i>[Signature]</i> DATE: 1.10.56		NUMBER OF SHEETS 6		A.G.S. N° 3017. SHEET 1		
MINISTRY OF SUPPLY APPLICATIONS FOR A.G.S. SHEETS TO :- AT P 4 BLOCK 'E', CHESSINGTON SURREY. GENERAL ENQUIRIES TO :- AD/SAE, ST GILES COURT, 1-13 ST GILES HIGH STREET, LONDON W.C.2						

COUPLING END - B.S.P.

M A R K	OUT. DIA. OF PIPE	Y		X	V	U	T	Q	P	N	M	TH'D SIZE	L			K			J			H		
		MAX	MIN										+0 -01	+0 -005	+0 -01	+01 -0	T	MAJOR DIAMETER		EFFECTIVE DIAMETER		MINOR DIAMETER		
																		MAX	MIN	MAX	MIN	MAX	MIN	MAX
A	3/16	.6250	.6170	.65	.20	5/32	.295	.39	.330	.10	.015	1/8 B.S.P.	28	.3777	.0048	.3729	.3601	.0042	.3559	.3372	.0080	.3292		
B	1/4	.6875	.6795	.65	.20	7/32	.410	.52	.440	.14	.025	1/4 B.S.P.	19	.5102	.0057	.5045	.4843	.0049	.4794	.4506	.0095	.4411		
BB	5/16	.7500	.7420	.72	.20	9/32	.480	.61	.525	.14	.025	60% WHIT FORM	19	.5922	.0057	.5865	.5663	.0048	.5615	.5326	.0093	.5233		
C	3/8	.8125	.8045	.74	.22	21/64	.550	.66	.580	.14	.025	3/8 B.S.P.	19	.6482	.0057	.6425	.6223	.0050	.6173	.5886	.0096	.5790		
CC	7/16	.8750	.8670	.77	.22	25/64	.600	.75	.650	.18	.035	75% WHIT FORM	14	.7394	.0067	.7327	.7043	.0060	.6983	.6586	.0118	.6468		
D	1/2	1.0000	.9920	.87	.22	1/2	.690	.83	.723	.18	.035	1/2 B.S.P.	14	.8144	.0067	.8077	.7793	.0056	.7737	.7336	.0109	.7227		

COMPONENT END - UNIFIED

M A R K	OUT DIA. OF PIPE	G	E	D	C	B	TH'D SIZE	Y Y	X X			V V			U U		
									MAJOR DIAMETER		EFFECTIVE DIAMETER		MINOR DIAMETER				
									MAX	MIN	MAX	MIN	MAX	MIN	MAX	MIN	
A	3/16	.35	.312	.610	.02	.063	3/8 U.N.F.	24	.3739	.0072	.3667	.3468	.0038	.3430	.3228	.0068	.3160
B	1/4	.40	.364	.670	.02	.075	7/16 U.N.F.	20	.4362	.0081	.4281	.4037	.0042	.3995	.3749	.0078	.3671
BB	5/16	.40	.426	.730	.02	.075	1/2 U.N.F.	20	.4987	.0081	.4906	.4662	.0043	.4619	.4374	.0079	.4295
C	3/8	.45	.481	.790	.02	.083	9/16 U.N.F.	18	.5611	.0087	.5524	.5250	.0045	.5205	.4929	.0085	.4844
CC	7/16	.45	.860	.860	.02	.094	5/8 U.N.F.	18	.6236	.0087	.6149	.5875	.0047	.5828	.5554	.0087	.5467
D	1/2	.50	.660	.980	.02	.094	3/4 U.N.F.	16	.7485	.0094	.7391	.7079	.0050	.7029	.6718	.0095	.6623

TITLE :- PIPE COUPLINGS (STEEL) - UNION ADAPTOR / UNIFIED ATTACHMENT END, 3/16 TO 1/2 - FOR USE WITH "O" RING GASKETS, IN AMERICAN (AND J10050) OR EQUIVALENT A.G.S. 3018 TAPPED BOSSES.

ISSUE R 1478
ALT N: 1018

MINISTRY OF SUPPLY
APPLICATIONS FOR A.G.S. SHEETS TO:-
A.T.P.4, BLOCK 'E', CHESSINGTON, SURREY.
GENERAL ENQUIRIES TO:-
A.D./S.A.E. ST GILES COURT, 1-13
ST GILES, HIGH STREET, LONDON W.C.2

R.A.E. APPROVAL
SIGNATURE: *[Signature]* DATE: 25.1.56
A.D./S.A.E. APPROVAL
SIGNATURE: *[Signature]* DATE: 1.10.56

NUMBER OF SHEETS
6

A.G.S. No
3017
SHEET 2

ALL DIMENSIONS ARE IN INCHES.

SEE A.G.S. 100 FOR GENERAL INFORMATION.

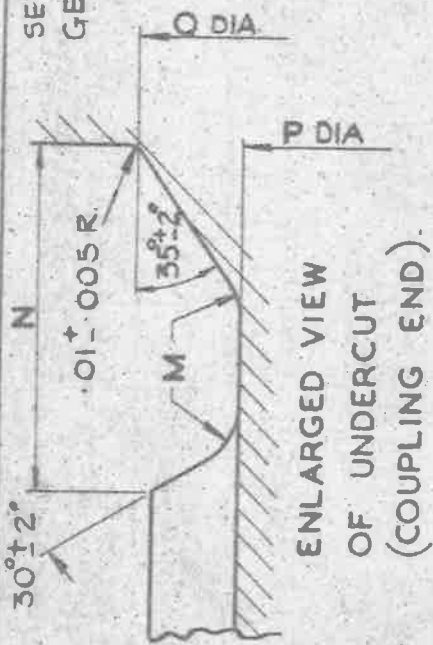

ENLARGED VIEW OF UNDERCUT (COUPLING END).

SMOOTH FINISH FREE FROM VISIBLE TOOL MARKS.

30±2° CHAMFER TO ROOT OF THREAD.

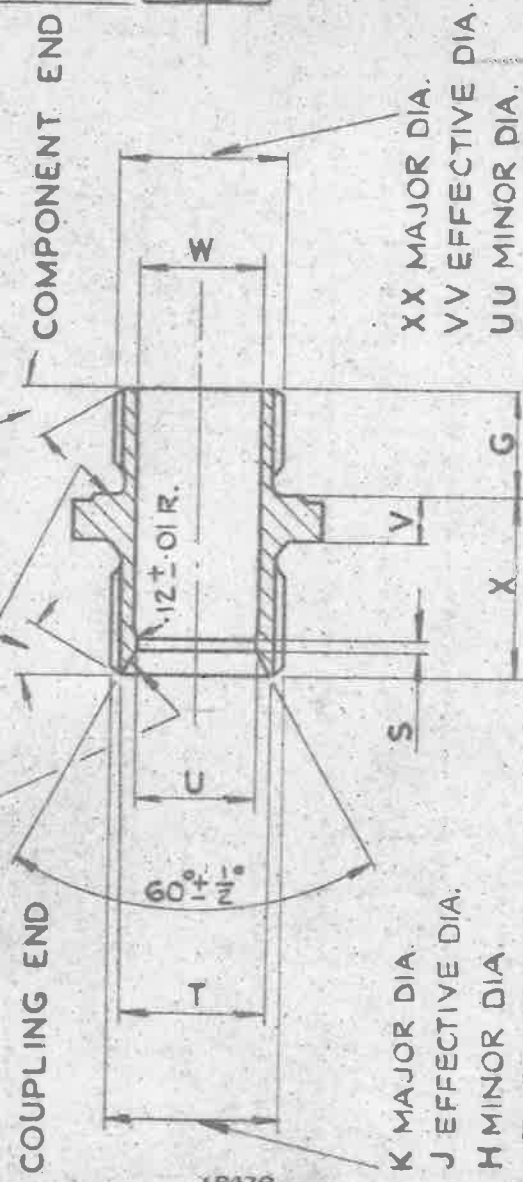

ENLARGED VIEW OF UNDERCUT & SHOULDER (COMPONENT END).

K MAJOR DIA.
J EFFECTIVE DIA.
H MINOR DIA.
L THREADS PER INCH.

XX MAJOR DIA.
VV EFFECTIVE DIA.
UU MINOR DIA.
YY THREADS PER INCH.

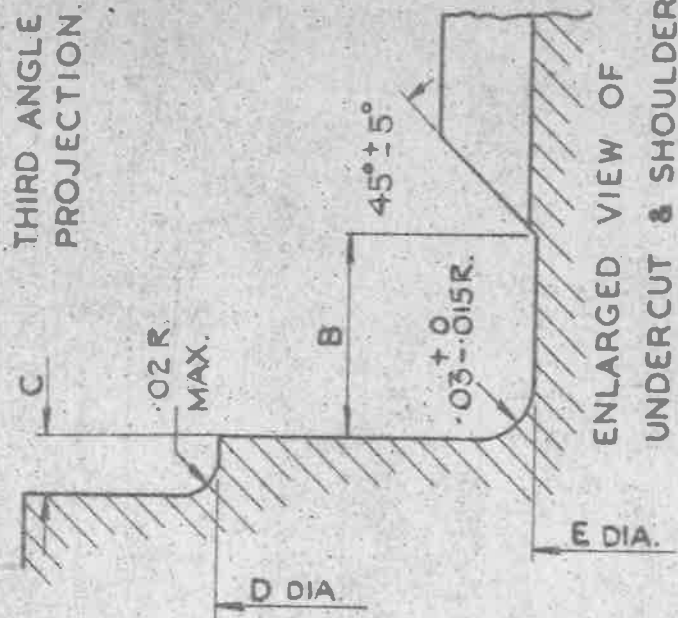

THIRD ANGLE PROJECTION.

ENLARGED VIEW OF UNDERCUT & SHOULDER (COMPONENT END).

A.G.S. 3017 - * TO BE LEGIBLY AND DURABLY MARKED IN POSITION SHOWN. (* MARK)

ALL SHARP EDGES AND BURRS TO BE REMOVED.

MACHINE ALL OVER.

MATERIAL :- NON - CORR. STEEL TO SPEC. D.T.D. 525 (LATEST ISSUE).

NOTE :- B.S.P. THREADS TO BE IN ACCORDANCE WITH B.S. SPEC. N° 84 (LATEST ISSUE) MEDIUM FIT, TRUNCATED. U.N. THREADS TO BE IN ACCORDANCE WITH B.S. SPEC. N° 1580 (LATEST ISSUE) CLASS 2A FIT.

TITLE :- PIPE COUPLINGS (STEEL) - UNION ADAPTOR / UNIFIED ATTACHMENT END, 5/8 TO 1 - FOR USE WITH "O" RING GASKETS, IN AMERICAN (AND 10050) OR EQUIVALENT A.G.S. 3018 TAPPED BOSSES

ISSUE 1

ALT. N° 1018

MINISTRY OF SUPPLY
APPLICATIONS FOR A.G.S. SHEETS TO :-
A.T.P.4, BLOCK 'E', CHESSINGTON, SURREY.
GENERAL ENQUIRIES TO :-
A.D./S.A.E. ST GILES COURT, 1-13
ST GILES HIGH STREET, LONDON W.C.2

R.A.E. APPROVAL	
SIGNATURE	DATE
<i>[Signature]</i>	25.9.56
A.D./S.A.E. APPROVAL	
SIGNATURE	DATE
<i>[Signature]</i>	1.10.56

NUMBER OF SHEETS 6

A.G.S. N° 3017 SHEET 3

SR478

ALL DIMENSIONS ARE IN INCHES.

A.G.S. 3017 SHEET 4

COUPLING END - B.S.P.

M A R K	O U T D I A .	Y		X	W	V	U	T	S	Q	P	N	M	L	K		J		H				
		MAX.	MIN.												MAJOR DIAMETER	EFFECTIVE DIAMETER	MINOR DIAMETER	MAX.	MIN.	MAX.	MIN.	MAX.	MIN.
E	5/8	1.1250	1.1150	.94	.65	.24	5/8	.760	.06	.91	.800	.18	.035	14	.8914	.0067	.8847	.8563	.0056	.8507	.8106	.0109	.7997
F	3/4	1.3125	1.3005	.99	.82	.24	3/4	.900	.06	1.05	.935	.18	.035	14	1.0304	.0067	1.0237	.9953	.0060	.9893	.9496	.0113	.9383
G	7/8	1.4375	1.4225	1.06	.90	.26	7/8	1.040	.08	1.19	1.085	.18	.035	14	1.1784	.0067	1.1717	1.1433	.0061	1.1372	1.0976	.0114	1.0862
H	1	1.6250	1.6100	1.06	1.02	.26	15/16	1.130	.08	1.31	1.180	.23	.045	11	1.2956	.0078	1.2878	1.2508	.0065	1.2443	1.1926	.0125	1.1801

COMPONENT END - UNIFIED

M A R K	O U T D I A .	G	E	D	C	B	T H ' D	Y Y	X X		V V		U U				
									MAJOR DIAMETER	EFFECTIVE DIAMETER	MAJOR DIAMETER	EFFECTIVE DIAMETER	MINOR DIAMETER	MINOR DIAMETER			
E	5/8	.55	.773	1.10	.03	.107	7/8	14	.8734	.0103	.8631	.8270	.0054	.8216	.7858	.0105	.7753
F	3/4	.65	.945	1.29	.03	.125	1 1/16	12	1.0608	.0114	1.0494	1.0067	.0057	1.0010	.9586	.0117	.9469
G	7/8	.65	.945	1.41	.03	.125	1 3/16	12	1.1858	.0114	1.1744	1.1317	.0057	1.1260	1.0836	.0117	1.0719
H	1	.65	1.195	1.60	.03	.125	1 5/16	12	1.3107	.0114	1.2993	1.2566	.0059	1.2507	1.2085	.0119	1.1966

TITLE: - PIPE COUPLINGS (STEEL)-UNION ADAPTOR UNIFIED ATTACHMENT END, 3/8 TO 1" FOR USE WITH "O" RING GASKETS, IN AMERICAN (AND .10050) OR EQUIVALENT A.G.S. 3018 TAPPED BOSSES.

ISSUE 1
 ALTN 1018

MINISTRY OF SUPPLY
 APPLICATIONS FOR A.G.S. SHEETS TO:-
 AT P 4 BLOCK 'E' CHESSINGTON SURREY
 GENERAL ENQUIRIES TO:-
 AD/SAE, ST GILES COURT, 1-13
 ST GILES HIGH STREET, LONDON W.C.2

RAE APPROVAL
 SIGNATURE: [Signature]
 DATE: 25.9.56
 A.D.S.A.E. APPROVAL
 SIGNATURE: [Signature]
 DATE: 1.10.56

NUMBER OF SHEETS
 6

A.G.S. NO.
 3017.
 SHEET 4

SEE A.G.S 100 FOR GENERAL INFORMATION.

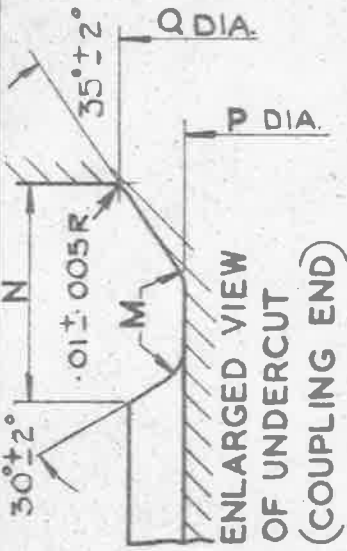

ENLARGED VIEW OF UNDERCUT (COUPLING END)

ALL DIMENSIONS ARE IN INCHES.

THIRD ANGLE PROJECTION

SMOOTH FINISH FREE FROM VISIBLE TOOL MARKS

AGS 3017-* TO BE LEGIBLY & DURABLY MARKED IN POSITION SHOWN (*MARK)

ENLARGED VIEW OF UNDERCUT & SHOULDER (COMPONENT END)

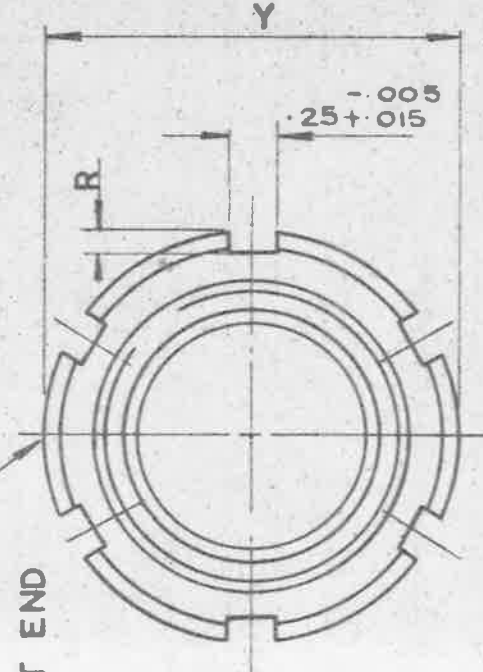

COMPONENT END

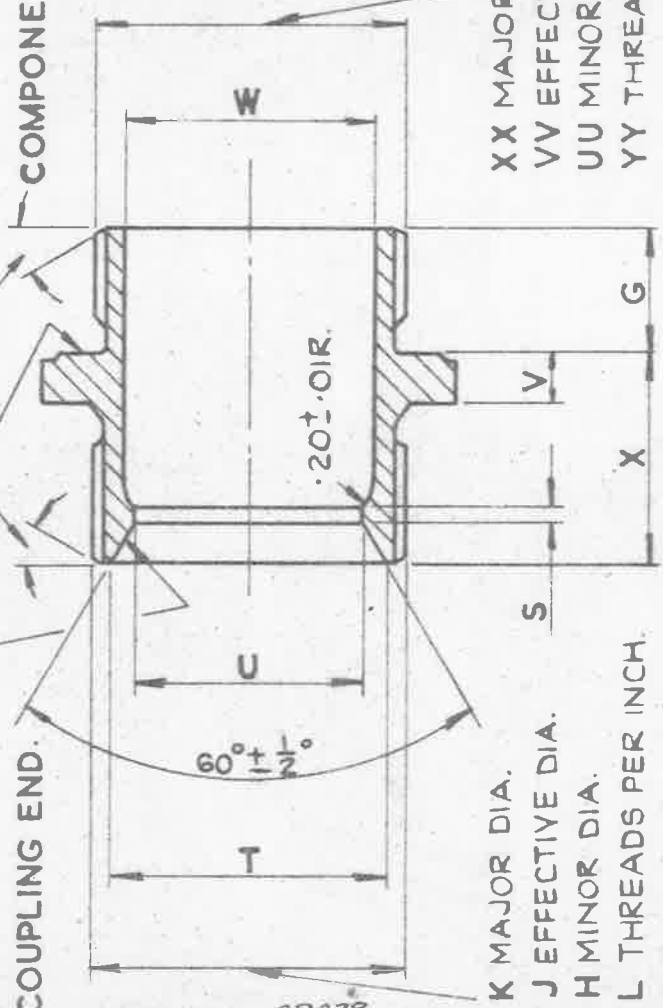

COUPLING END

- XX MAJOR DIA.
- VV EFFECTIVE DIA.
- UU MINOR DIA.
- YY THREADS PER INCH
- K MAJOR DIA.
- J EFFECTIVE DIA.
- H MINOR DIA.
- L THREADS PER INCH

ALL SHARP EDGES AND BURRS TO BE REMOVED

MACHINE ALL OVER

MATERIAL :- NON-CORR. STEEL TO SPEC. D.T.D 525 (LATEST ISSUE)

NOTE :- B.S.P. THREADS TO BE IN ACCORDANCE WITH B.S. SPEC.Nº 84 (LATEST ISSUE) MEDIUM FIT, TRUNCATED U.N. THREADS TO BE IN ACCORDANCE WITH B.S. SPEC.Nº 1580 (LATEST ISSUE) CLASS 2A FIT.

TITLE :- PIPE COUPLINGS (STEEL) - UNION ADAPTOR UNIFIED ATTACHMENT END, 1/4 TO 2 - FOR USE WITH 'O' RING GASKETS, IN AMERICAN (AND 10050) OR EQUIVALENT A.G.S. 3018 TAPPED BOSSES.

ISSUE	1				
ALT Nº	1018				

MINISTRY OF SUPPLY
 APPLICATIONS FOR A.G.S. SHEETS TO :-
 A.T.P 4 BLOCK 'E', CHESSINGTON, SURREY.
 GENERAL ENQUIRIES TO :-
 A.D./S.A.E. ST GILES COURT, 1-13
 ST. GILES HIGH STREET, LONDON WC2

R.A.E. APPROVAL		NUMBER OF SHEETS	A.G.S. Nº
SIGNATURE	DATE		
<i>[Signature]</i>	25.9.16	6	3017.
A.O.S.A.E. APPROVAL			
SIGNATURE	DATE		SHEET 5
<i>[Signature]</i>	1.10.26		

SR478

COUPLING END - B.S.P.

M	OUT. DIA. OF PIPE	Y	X	W	V	U	T	S	R	Q	P	N	M	TH'D SIZE	L			K			J			H							
															T	P	I	MAX	TOL	MIN	MAX	TOL	MIN	MAX	TOL	MIN	MAX	TOL	MIN	MAX	TOL
J	1 1/4	2.16	2.14	1.11	1.30	26	3/16	1.45	.08	.125	1.66	1.520	.23	.045	1/4 B.S.P.	11	1.6366	.0078	1.6288	1.5918	.0069	1.5849	1.5336	.0129	1.5207						
K	1 1/2	2.37	2.35	1.15	1.56	26	7/16	1.68	.10	.125	1.89	1.750	.23	.045	1/2 B.S.P.	11	1.8686	.0078	1.8608	1.8238	.0072	1.8166	1.7656	.0132	1.7524						
L	1 3/4	2.85	2.83	1.25	1.80	26	5/8	1.92	.10	.150	2.12	1.985	.23	.045	3/4 B.S.P.	11	2.1026	.0078	2.0948	2.0578	.0073	2.0505	1.9996	.0133	1.9863						
M	2	3.16	3.14	1.30	2.02	26	7/8	2.15	.10	.150	2.35	2.215	.23	.045	2 B.S.P.	11	2.3336	.0078	2.3258	2.2888	.0073	2.2815	2.2306	.0134	2.2172						

COMPONENT END - UNIFIED.

M	OUT. DIA. OF PIPE	G	E	D	C	B	TH'D SIZE	YY	XX			VV			UU				
									T	P	I	MAX	TOL	MIN	MAX	TOL	MIN	MAX	TOL
J	1 1/4	.65	1.507	2.00	.04	.125	5/8 U.N.S.	12	1.6232	.0114	1.6118	1.5691	.0059	1.5632	1.5210	.0119	1.5091		
K	1 1/2	.65	1.756	2.20	.04	.125	7/8 U.N.S.	12	1.8732	.0114	1.8618	1.8191	.0059	1.8132	1.7710	.0119	1.7591		
L	1 3/4	.65	2.131	2.70	.04	.125	2 1/4 U.N.S.	12	2.2481	.0114	2.2367	2.1940	.0062	2.1878	2.1459	.0122	2.1337		
M	2	.65	2.381	3.00	.04	.125	2 1/2 U.N.S.	12	2.4981	.0114	2.4867	2.4440	.0062	2.4378	2.3959	.0122	2.3837		

TITLE: PIPE COUPLINGS (STEEL) - UNION ADAPTOR / UNIFIED ATTACHMENT END, 1/4 TO 2 - FOR USE WITH O-RING GASKETS, IN AMERICAN (AND JOOSE) OR EQUIVALENT A.G.S. 3018 TAPPED BOSSES

ISSUE SR 1478
 MOD/AGS
 ALT No 1018

MINISTRY OF SUPPLY
 APPLICATIONS FOR A.G.S. SHEETS TO:-
 AT P4, BLOCK 'E', CHESSINGTON, SURREY.
 GENERAL ENQUIRIES TO:-
 A.D./SAE, ST GILES COURT, 1-13
 ST GILES HIGH STREET, LONDON W.C.2

RAE APPROVAL
 SIGNATURE: *[Signature]* DATE: 25.4.56
 A.D.SAE APPROVAL
 SIGNATURE: *[Signature]* DATE: 1.10.56

NUMBER OF SHEETS
 6

A.G.S. No 3017
 SHEET 6

A.G.S. 3017-SHEET 3

NO.	DESCRIPTION	QTY.	REVISIONS
1	AS SHOWN	1	
2	SEE DET.		
3	SEE DET.		
4	SEE DET.		
5	SEE DET.		

SM 2026



K MAJOR DIA.
J EFFECTIVE DIA.
H MINOR DIA.
L THREADS PER INCH

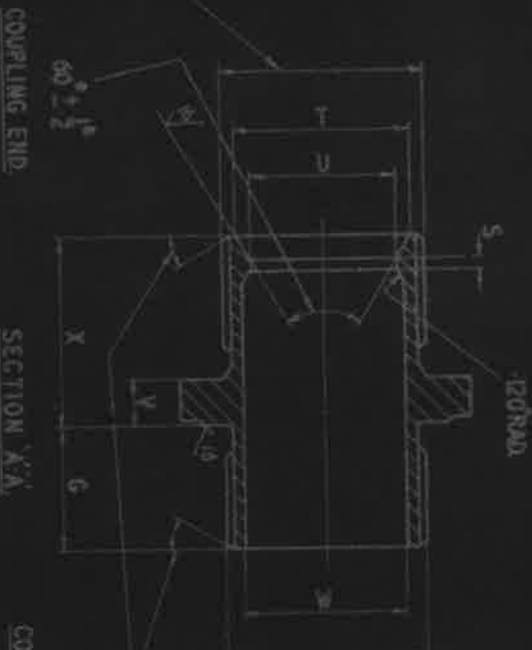

COMPONENT END

APPROVED WORKING PRESSURE
PIPE S/D WORKING PRESSURE
3/8 TO 1" 500 LB./SQ. IN.

MACHINE ALL OVER
SEE A.G.S. 100 FOR GENERAL INFORMATION.
B.S.P.E. THREADS TO BE IN ACCORDANCE WITH B.S. SPEC. 2775MEDIUM
FITTING CLASS UN. THREADS TO BE IN ACCORDANCE WITH B.S. SPEC.
2775B LOW CLASS 2A.F.F.I.

NO.	REVISIONS	DATE	BY	CHECKED BY
1	ISSUED			

MATERIALS		COUPLING END		COMPONENT END		FINISHES		TOLERANCES	
HT	RS 116	SCALE	SCALE	SCALE	SCALE	SCALE	SCALE	SCALE	SCALE
PIPE COUPLING (STEEL) UNION ADAPTOR		UNIFIED ATTACHMENT END 3/8 TO 1" FOR USE		WITH O-RING GASKETS IN AMERICAN MANUFACTURE		FOR ESTABLISHMENT A.G.S. 3017 TAPPED ROSS'S.		THIRD ANGLE PROJECTION.	
STAINLESS STEEL		WATERPROOF							
								A.G.S. 3017-SHEET 3	

AGS 3017 SHEET 5

REV	DATE	BY	CHKD
1	8.2.72		
2	8.2.72		
3	8.2.72		
4	8.2.72		
5	8.2.72		

SM2026

PART No. HERE

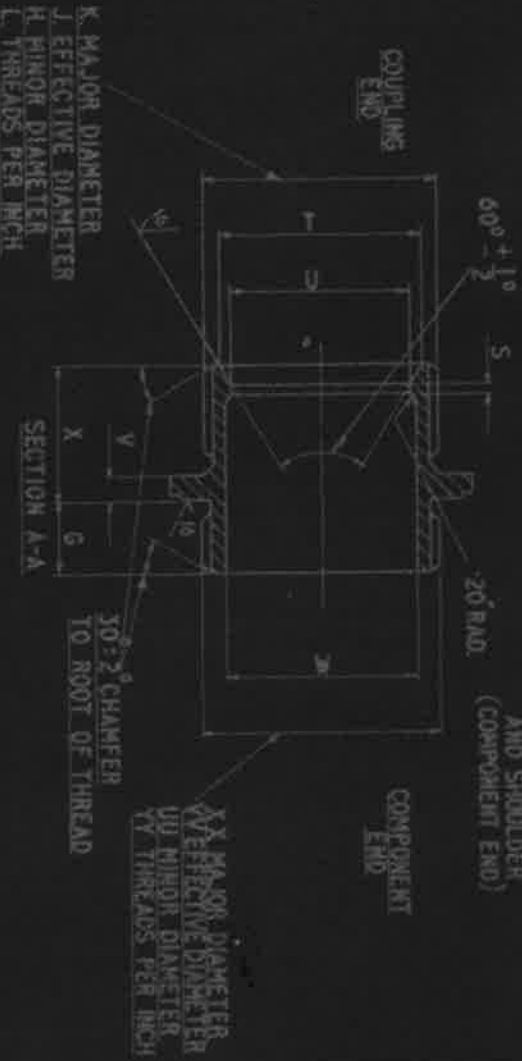

MACHINE ALL OVER
 SEE AGS 100 FOR GENERAL INFORMATION
 BS PT THREADS TO BE IN ACCORDANCE WITH BS SPEC 2770
 MEDIUM FIT, TRUNCATED UN THREADS TO BE IN ACCORDANCE
 WITH BS SPEC 1580 CLASS 2A FIT

APPROVED WORKING PRESSURE
 PIPE CVD. WORKING PRESSURE
 1 1/2" TO 2" 200 LB. (90.0) IN

PART No.	HT	PI	SCALE	UNIT	MATERIAL	FINISH	TOLERANCE	SURFACE	TREATMENT	OTHER
	HT									
AGS 3017 SHEET 5					STAINLESS STEEL					