

NOTE:- RE-PRODUCED FROM MESSERS
ARMSTRONG WHITWORTH DRG. NO 319

MINISTRY OF
SUPPLY

AGS. NO 934.

SHEET NO 1

NO OF SHEETS 1

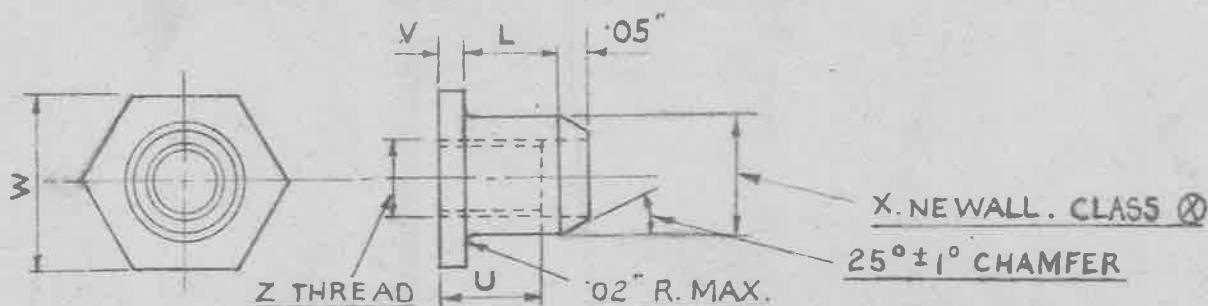

TOLERANCE $\pm .010$ " UNLESS OTHERWISE STATED.

SIZE X *		MARK	L	Z	W	V	U
NOMINAL	LIMITS						
3/16	.1855" .1865"	C.L.	.35"	6 B.A.	.245" .248"	.05"	.15"
		C.M.	.25"				
		C.S.	.15"				
7/32	.2167" .2177"	D.L.	.40"	4 B.A.	.321" .324"	.07"	.20"
		D.M.	.30"				
		D.S.	.20"				
1/4	.2480" .2490"	E.L.	.45"	4 B.A.	.321" .324"	.07"	.20"
		E.M.	.35"				
		E.S.	.20"				
9/32	.2792" .2802"	F.L.	.50"	2 B.A.	.410" .413"	.07"	.25"
		F.M.	.40"				
		F.S.	.25"				
5/16	.3105" .3115"	G.L.	.55"	2 B.A.	.440" .445"	.07"	.25"
		G.M.	.40"				
		G.S.	.25"				
3/8	.3730" .3740"	J.L.	.65"	7/32 B.S.F.	.520" .525"	.07"	.28"
		J.M.	.50"				
		J.S.	.30"				
7/16	.4355" .4365"	L.L.	.80"	7/32 B.S.F.	.595" .600"	.08"	.28"
		L.M.	.60"				
		L.S.	.35"				
1/2	.4980" .4990"	N.L.	.90"	1/4 B.S.F.	.595" .600"	.08"	.30"
		N.M.	.65"				
		N.S.	.40"				

* THESE DIMENSIONS TAKEN OVER CADMIUM COATING

SPECIFICATION :-

THE MATERIAL TO BE STEEL TO B.S. SPECIFICATION S2, S11. OR D.T.D. 153.

(LATEST ISSUES). SCREW THREADS :-

BRITISH ASSOCIATION (B.A.) TO B.S. SPECN NO 93.

BRITISH STANDARD. FINE (B.S.F.) TO B.S. SPECN NO 84-1940, MEDIUM FIT

THE SCREW THREADS AFTER BEING PLATED SHALL BE REQUIRED TO PASS APPROVED GAUGES.

FINISH :- TO BE CADMIUM PLATED TO SPEC. D.T.D. 904. (LATEST ISSUE)

RE-

ISSUED BY THE ROYAL AIRCRAFT ESTABLISHMENT	TITLE :- FERRULES (PLATED) FOR SCREWED ROD			DRAWN M.W. SHIPPEY	TRACED G.A.F. D.A.P. 21-12-49
	ISSUE NO	3		CHECKED	APPROVED
	ALTERN NO	AS. NO AGS/663		T.H. BRASHER RE-Checked C.T. Reynolds.	

NOTE:- RE-PRODUCED FROM MESSRS.
ARMSTRONG WHITWORTH DRG. NO 319

MINISTRY OF
SUPPLY

AGS. NO 934.

SHEET NO 1

NO OF SHEETS 1

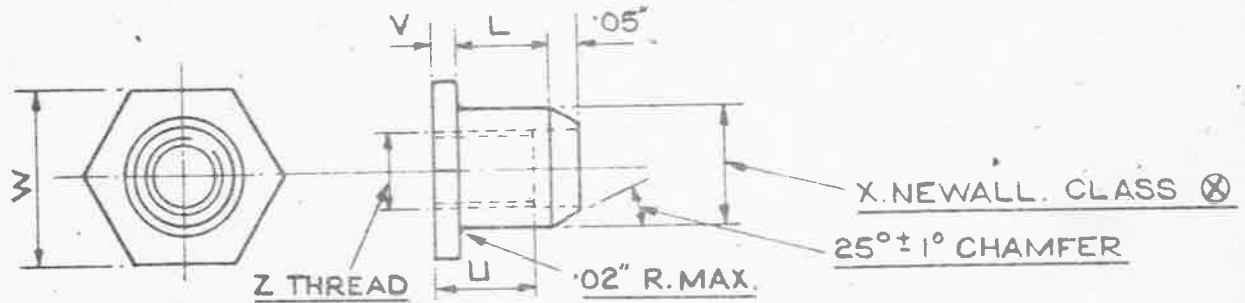

TOLERANCE $\pm .010$ " UNLESS OTHERWISE STATED

12-3-37
403926/35

SIZE X *		MARK	L	Z	W	V	U
NOMINAL	LIMITS						
3/16	.1855" .1865"	C.L.	.35"	6 B.A.	.245" .248"	.05"	.15"
		C.M.	.25"				
		C.S.	.15"				
7/32	.2167" .2177"	D.L.	.40"	4 B.A.	.321" .324"	.07"	.20"
		D.M.	.30"				
		D.S.	.20"				
1/4	.2480" .2490"	E.L.	.45"	4 B.A.	.321" .324"	.07"	.20"
		E.M.	.35"				
		E.S.	.20"				
9/32	.2792" .2802"	F.L.	.50"	2 B.A.	.410" .413"	.07"	.25"
		F.M.	.40"				
		F.S.	.25"				
5/16	.3105" .3115"	G.L.	.55"	2 B.A.	.440" .445"	.07"	.25"
		G.M.	.40"				
		G.S.	.25"				
3/8	.3730" .3740"	J.L.	.65"	7/32 B.S.F.	.520" .525"	.07"	.28"
		J.M.	.50"				
		J.S.	.30"				
7/16	.4355" .4365"	L.L.	.80"	7/32 B.S.F.	.595" .600"	.08"	.28"
		L.M.	.60"				
		L.S.	.35"				
1/2	.4980" .4990"	N.L.	.90"	1/4 B.S.F.	.595" .600"	.08"	.30"
		N.M.	.65"				
		N.S.	.40"				

OBSOLESCE - NOT TO BE
USED ON NEW DESIGN WORK.

* THESE DIMENSIONS TAKEN OVER CADMIUM COATING

SPECIFICATION:-

THE MATERIAL TO BE STEEL TO B.S. SPECIFICATION S2, S11. OR D.T.D. 153.
(LATEST ISSUES) SCREW THREADS:-
BRITISH ASSOCIATION (B.A) TO B.S. SPECN No 93.
BRITISH STANDARD FINE (B.S.F.) TO B.S. SPECN No 84-1940, MEDIUM FIT.
THE SCREW THREADS AFTER BEING PLATED SHALL BE REQUIRED
TO PASS APPROVED GAUGES.

FINISH:- TO BE CADMIUM PLATED TO SPEC. D.T.D. 904. (LATEST ISSUE)

ISSUED BY THE ROYAL AIRCRAFT ESTABLISHMENT	TITLE :- FERRULES (PLATED) FOR SCREWED ROD			DRAWN M.W. SHIPPEY	TRACED J.S. 28.5.47
	ISSUE NO	3	4	CHECKED J.H. BRASHER	APPROVED 15 3 37
	ALTERN NO	AS. No AGS/663	MOD/AGS 997	SM 874	RE-CHECKED CT Reynolds.