

FOR MARK J ONLY, EIGHT HOLES EQUALLY SPACED AND EIGHT FLATS

AGS 958/\* TO BE LEGIBLY AND DURABLY MARKED ON THIS OR OPPOSITE FACE (\* MARK N<sup>o</sup>).

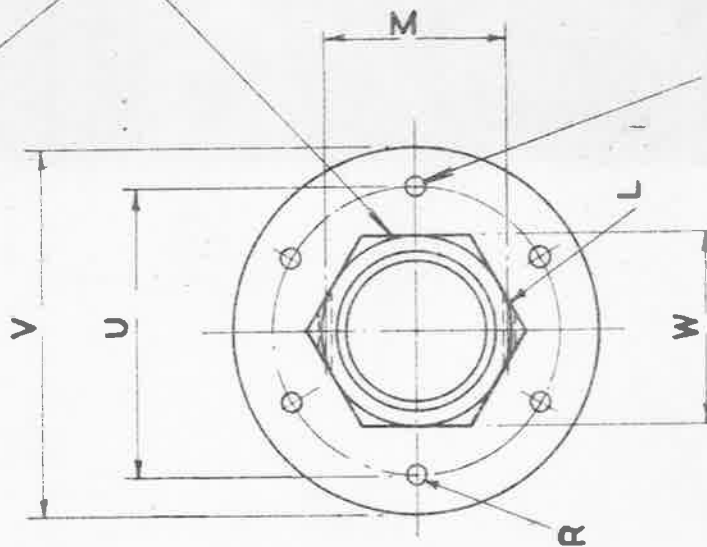

SIX HOLES EQUALLY SPACED.

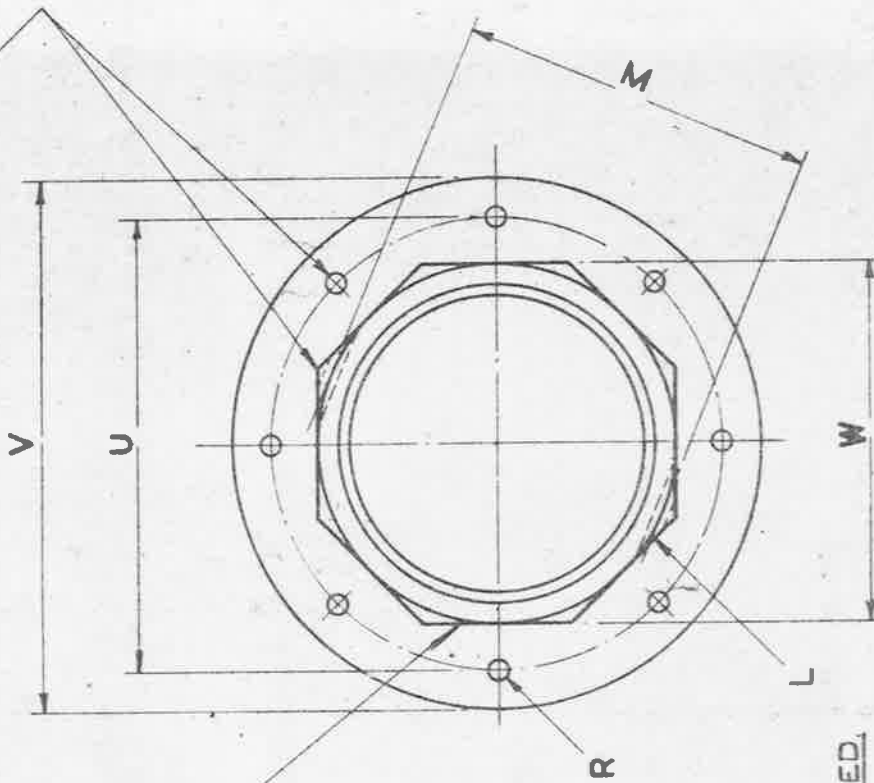
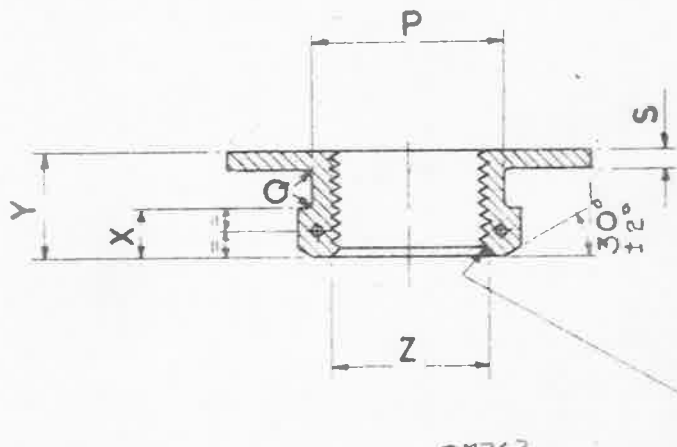

30°±2° CHAMFER TO ROOT OF THREAD.

MATERIAL :- LIGHT ALLOY TO B.S. SPEC. L-1, L-33, D.T.D. 423 OR 424, (LATEST ISSUES)

FINISH :- ANODISED TO SPEC N<sup>o</sup> D.T.D. 910, (LATEST ISSUE)

NOTE :- SCREW THREADS TO B.S. SPEC. N<sup>o</sup> 84 - 1940, MEDIUM FIT.

NOTE :- ALL SHARP EDGES AND BURRS TO BE REMOVED.

TITLE:- FEMALE FLANGES (LIGHT ALLOY)

ISSUE 9  
ALT. N<sup>o</sup> MOD/AGS 8/1

SM363

MINISTRY OF SUPPLY  
APPLICATIONS FOR A.G.S. SHEETS TO  
ATP 4A, THAMES HOUSE, MILLBANK, S.W.1.

R.A.E. APPROVAL

AD. S.A.E. APPROVAL

SIGNATURE

DATE

SIGNATURE

DATE

SHEET N<sup>o</sup>

18.5.50.

G.T. Venkatesh

7/2/50

GENERAL INQUIRIES TO:-  
AD. S.A.E. THAMES HOUSE, MILLBANK, S.W.1.

N<sup>o</sup> OF SHEETS

2

A.G.S. N<sup>o</sup> 958

MARK	Z	Y	X	W		V	U	S	R	Q	P	M	L
				MAX	MIN								
Nº	B.S.P. THREAD	±.01"	±.005"	MAX	MIN	±.005"	±.015"	±.005"	DRILL	±.005"	±.005"	±.01"	DRILL
A	1 1/8	.32"	.15"	.525"	.520"	1.42"	1.025"	.10"	7/64	.03"	.500"	.48"	1 1/16
B	1 1/4	.35"	.18"	.710"	.705"	1.50"	1.100"	.10"	7/64	.03"	.595"	.67"	1 1/16
C	3/8	.45"	.22"	.820"	.815"	1.70"	1.300"	.10"	7/64	.03"	.740"	.79"	1 1/16
D	1 1/2	.55"	.25"	1.010"	1.002"	1.90"	1.500"	.10"	7/64	.03"	.990"	.96"	1 1/16
E	5/8	.65"	.28"	1.100"	1.092"	2.00"	1.600"	.10"	7/64	.03"	1.060"	1.06"	1 1/16
F	3/4	.65"	.31"	1.200"	1.192"	2.10"	1.700"	.10"	7/64	.03"	1.180"	1.17"	1 1/16
G	7/8	.67"	.33"	1.390"	1.382"	2.25"	1.850"	.10"	7/64	.03"	1.340"	1.37"	.076" (Nº 48)
H	1"	.70"	.35"	1.480"	1.468"	2.35"	1.950"	.10"	7/64	.03"	1.460"	1.47"	.076" (Nº 48)
J	1 1/4	.80"	.41"	1.860"	1.845"	2.75"	2.350"	.10"	7/64	.03"	1.800"	1.85"	.076" (Nº 48)
K	1 1/2												
M	2"												
P	2 1/2												

TITLE:-- FEMALE FLANGES (LIGHT ALLOY)

ISSUE I

ALT. Nº 811

MINISTRY OF SUPPLY

APPLICATIONS FOR A.G.S. SHEETS TO: A.T.P. 4A. THAMES HOUSE, MILLBANK, S.W.1.

GENERAL INQUIRIES TO:-- A.D.S.A.E. THAMES HOUSE, MILLBANK, S.W.1.

R.A.E. APPROVAL SIGNATURE DATE 16.5.50

AD. S.A.E. APPROVAL SIGNATURE DATE 7/9/50

SHEET Nº 2

Nº OF SHEETS 2

A.G.S. Nº 958